

USER MANUAL

Range Hood

Power supply: 120V
Rated power: 323W
Frequency: 60Hz

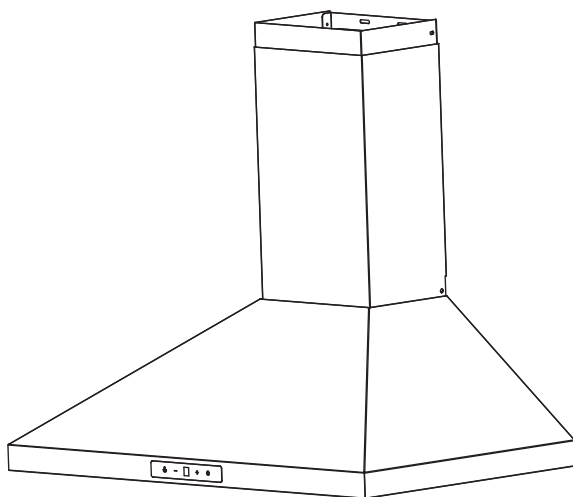

Free 3 months extension of the original limited warranty period!* Simply text a picture of your proof of purchase to:

1-844-224-1614

*The warranty extension is for the three months immediately following the completion of the product's original warranty period.

⚠️ INTENDED FOR RESIDENTIAL COOKING USE ONLY ⚠️

⚠️ WARNING

WARNING alerts you to situations that may cause serious body harm, death or property damage.

⚠️ CAUTION

CAUTION indicates a potentially hazardous situation which, if not avoided, may result in minor or moderate injury.

🔧 IMPORTANT

IMPORTANT indicates installation, operation, maintenance or valuable information that is not hazard related.

⚠️ WARNING

TO REDUCE THE RISK OF FIRE, ELECTRIC SHOCK OR INJURY TO PERSONS, OBSERVE THE FOLLOWING:

1. Use this unit only in the manner intended by the manufacturer. If you have questions, contact the manufacturer at the address or telephone number listed in the warranty.
2. Before servicing or cleaning unit, unplug and switch power off at service panel and lock service disconnecting means to prevent power from being switched on accidentally. When the service disconnecting means cannot be locked, securely fasten a prominent warning device, such as a tag, to the service panel.
3. Installation work and electrical wiring must be done by qualified personnel in accordance with all applicable codes and standards, including fire-rated construction codes and standards.
4. Sufficient air is needed for proper combustion and exhausting of gases through the flue (chimney) of fuel burning equipment to prevent backdrafting. Follow the heating equipment manufacturer's guidelines and safety standards such as those published by the National Fire Protection Association (NFPA) and the American Society for Heating, Refrigeration and Air Conditioning Engineers (ASHRAE) and the local code authorities.
5. When cutting or drilling into wall or ceiling, do not damage electrical wiring and other hidden utilities.
6. Ducted fans must always be vented to the outdoors.
7. Do not use this unit with any solid-state speed control device.
8. **TO REDUCE THE RISK OF FIRE, USE ONLY METAL DUCTWORK.**
9. This unit must be grounded. This appliance is equipped with a cord having a grounding wire with a grounding plug. The plug must be plugged into an outlet that is properly installed and grounded.
10. Do not use an extension cord. If the power supply cord is too short, have a qualified electrician install an outlet near the appliance.
11. When applicable local regulations comprise more restrictive installation and/or certification requirements, the aforementioned requirements prevail on those of this document and the installer agrees to conform to these at his own expense.

TO REDUCE THE RISK OF A RANGE TOP GREASE FIRE:

- a) Never leave surface units unattended at high settings. Boilovers cause smoking and greasy spillovers that may ignite. Heat oils slowly on low or medium settings.
- b) Always turn hood ON when cooking at high heat or when flambéing food (i.e.: Crêpes Suzette, Cherries Jubilee, Peppercorn Beef Flambé).
- c) Clean ventilating fans frequently. Grease should not be allowed to accumulate on fan, filters or in exhaust ducts.
- d) Use proper pan size. Always use cookware appropriate for the size of the surface element.

⚠️ WARNING

TO REDUCE THE RISK OF INJURY TO PERSONS IN THE EVENT OF A RANGE TOP GREASE FIRE, OBSERVE THE FOLLOWING*:

1. **SMOTHER FLAMES** with a close-fitting lid, cookie sheet or metal tray, then turn off the burner. **BE CAREFUL TO PREVENT BURNS. IF THE FLAMES DO NOT GO OUT IMMEDIATELY, EVACUATE AND CALL THE FIRE DEPARTMENT.**
2. **NEVER PICK UP A FLAMING PAN** — You may be burned.
3. **DO NOT USE WATER**, including wet dishcloths or towels — This could cause a violent steam explosion.
4. Use an extinguisher **ONLY** if:
 - A. You own a Class ABC extinguisher and you know how to operate it.
 - B. The fire is small and contained in the area where it started.
 - C. The fire department has been called.
 - D. You can fight the fire with your back to an exit.
5. Based on "Kitchen Fire Safety Tips" published by NFPA.

⚠️ CAUTION

1. For indoor use only.
2. For general ventilating use only. Do not use to exhaust hazardous or explosive materials and vapors.
3. To avoid motor bearing damage and noisy and/or unbalanced impeller, keep drywall spray, construction dust, etc. off power unit.
4. Install the vent hood in a location away from strong drafts, such as windows, door, and strong HVAC vent for best performance
5. The minimum hood distance above cooktop must not be less than 25-5/8". For best capture of cooking impurities, the bottom of the hood should be at a maximum of 29-1/2" above cooking surface.
6. Two installers are recommended because of the large size and weight of this unit.
7. To reduce the risk of fire and to properly exhaust air, be sure to duct air outside — Do not exhaust air into spaces within walls or ceiling or into attics, crawl space or garage.
8. Because of the high exhausting capacity of this unit, you should make sure enough air is entering the house to replace exhausted air by opening a window close to or in the kitchen.
9. Always leave safety grills and filters in place. Without these components, operating blowers could catch onto hair, fingers and loose clothing.
10. The vent hood and filters should be cleaned frequently.

SAVE THESE INSTRUCTIONS

COMPONENTS

Ref.	Qty.	Product Components
1	1	Hood Body, complete with: Controls, Light, Blower, Filter.
2.1	1	Lower Decorative Chimney
2.2	1	Upper Decorative Chimney
3	2	The Activated Charcoal filter (optional)
4	2	Grease filter (30")
	3	Grease filter (36")

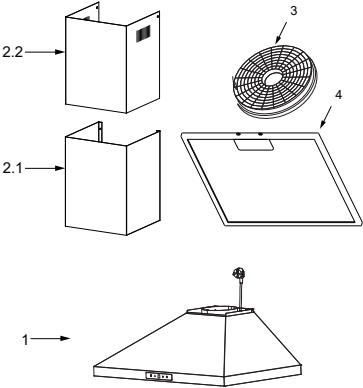

Qty.	Documentation
1	Instruction Manual

Ref.	Qty.	Optional Installation Components
10	7	Screws M5 x 1.97"
11	7	Wall Plugs
12	6	Screws M4.2 x 0.37"
20	1	Hood fixing bracket
21	1	Chimney fixing bracket

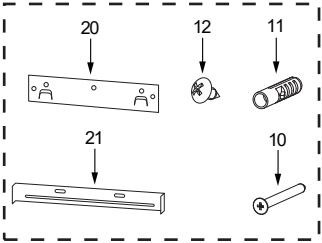

DIMENSIONS

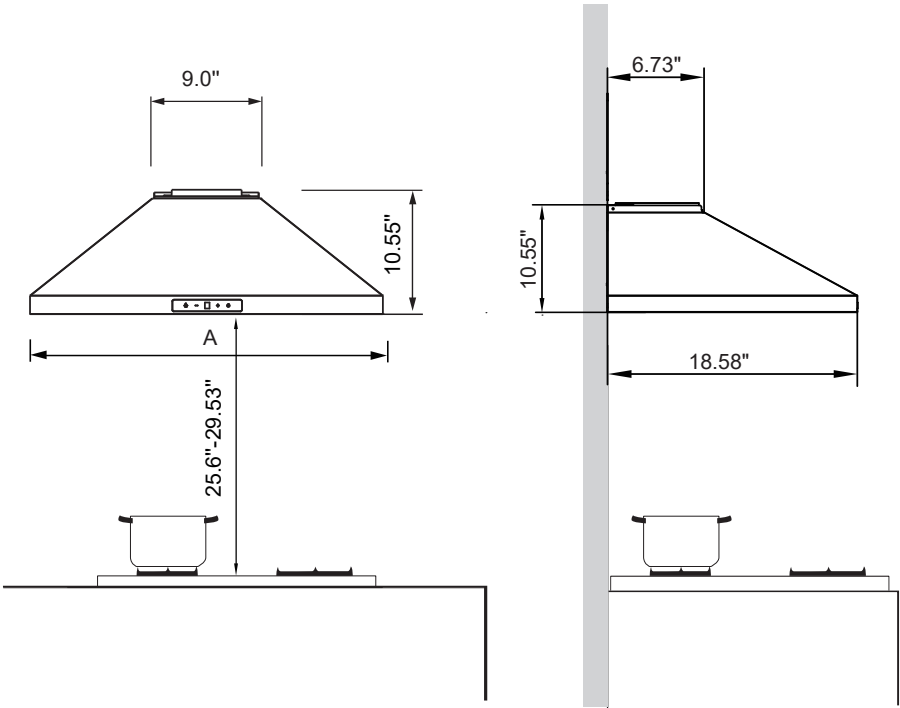

	CVP36W7AST	CVP30W7AST
A	35.4"	30"

INSTALLATION PREPARATION

1. SELECT INSTALLATION TYPE

A. Vented Installation

B. Non-Vented / Recirculation Installation

A. Vented Installation

Roof Discharge

This canopy hood is designed for venting through the roof or wall.

A 6" round vent system is needed for installation (not included). The hood exhaust opening is 6" round.

Vent system can terminate either through the roof or wall.
To vent through a wall, a 90° elbow is needed.

Rear Discharge

A 90° elbow may be installed immediately above the hood.

WARNING

TO REDUCE THE RISK OF FIRE, USE ONLY METAL DUCTWORK.

If it is not possible to vent cooking fumes and vapors to the outside, the hood can be used in the non-vented (recirculating) version, fitting a charcoal filter and the deflector (not included, you can decide whether to use according to your installation environment). Fumes and vapors are recycled through the top grille.

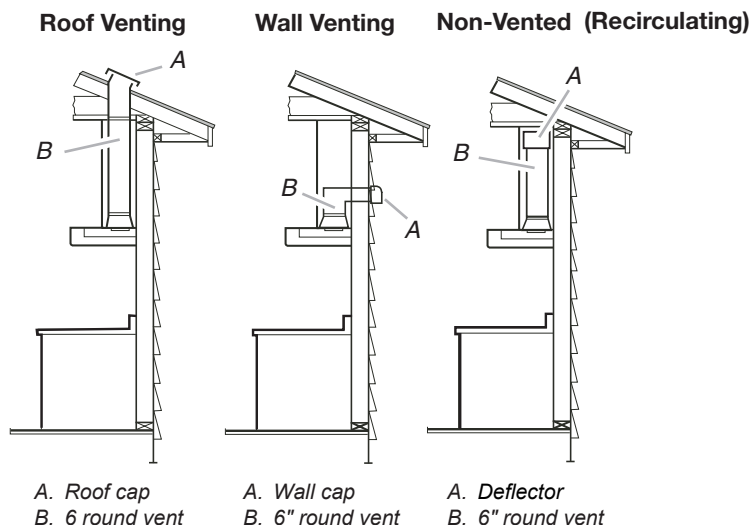

Local building codes may require the use of makeup air systems when using ventilation systems greater than specified CFM of air movement. The specified CFM varies from locale to locale. Consult your HVAC professional for specific requirements in your area.

INSTALLATION PREPARATION

Vents and electrical should be installed in the gray shaded areas to provide a clean finished look

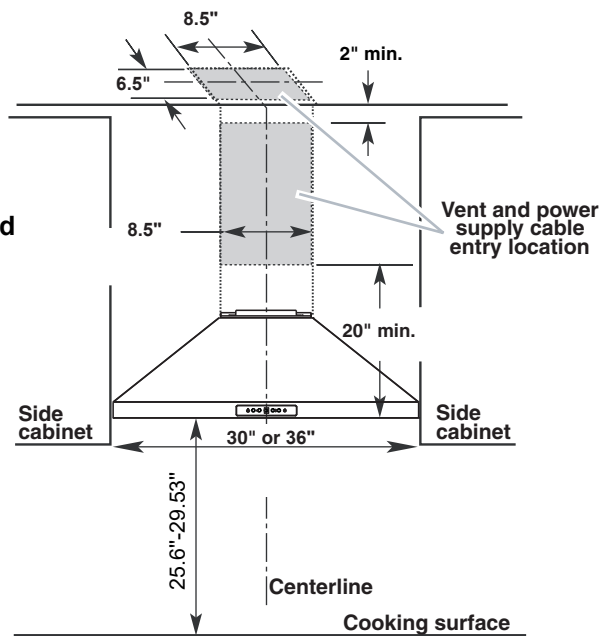

⚠ CAUTION

- Vent system must terminate to the outdoors except for non-vented (recirculating) installations.
- Do not terminate the vent system in an attic or other enclosed area.
- Do not use 4" laundry-type wall cap (plastic). Only use a metal exterior exhaust vent.
- Use metal vent only. Rigid metal vent is recommended for best performance.
- All vent joints should be taped and sealed with 2" metal foil tape
- The length of vent system and number of elbows should be kept to a minimum to provide efficient performance.

For the Most Efficient and Quiet Operation:

- Use no more than three 90° elbows.
- Make sure there is a minimum of 24" of straight vent between the elbows if more than 1 elbow is used.
- Do not install 2 elbows together.
- Use clamps to seal all joints in the vent system.
- Use caulking to seal exterior wall or roof opening around the cap.
- The size of the vent should be uniform.

Hood Mounting Screw Installation

1. Determine and mark the centerline on the wall where the hood will be installed.
2. Select a mounting height between a minimum of 25.6" and a suggested maximum of 29.53" above the range to the bottom of the hood.
Mark a reference line on the wall.
3. Tape template in place, aligning the template centerline and bottom of template with hood bottom line and with the centerline marked on the wall.

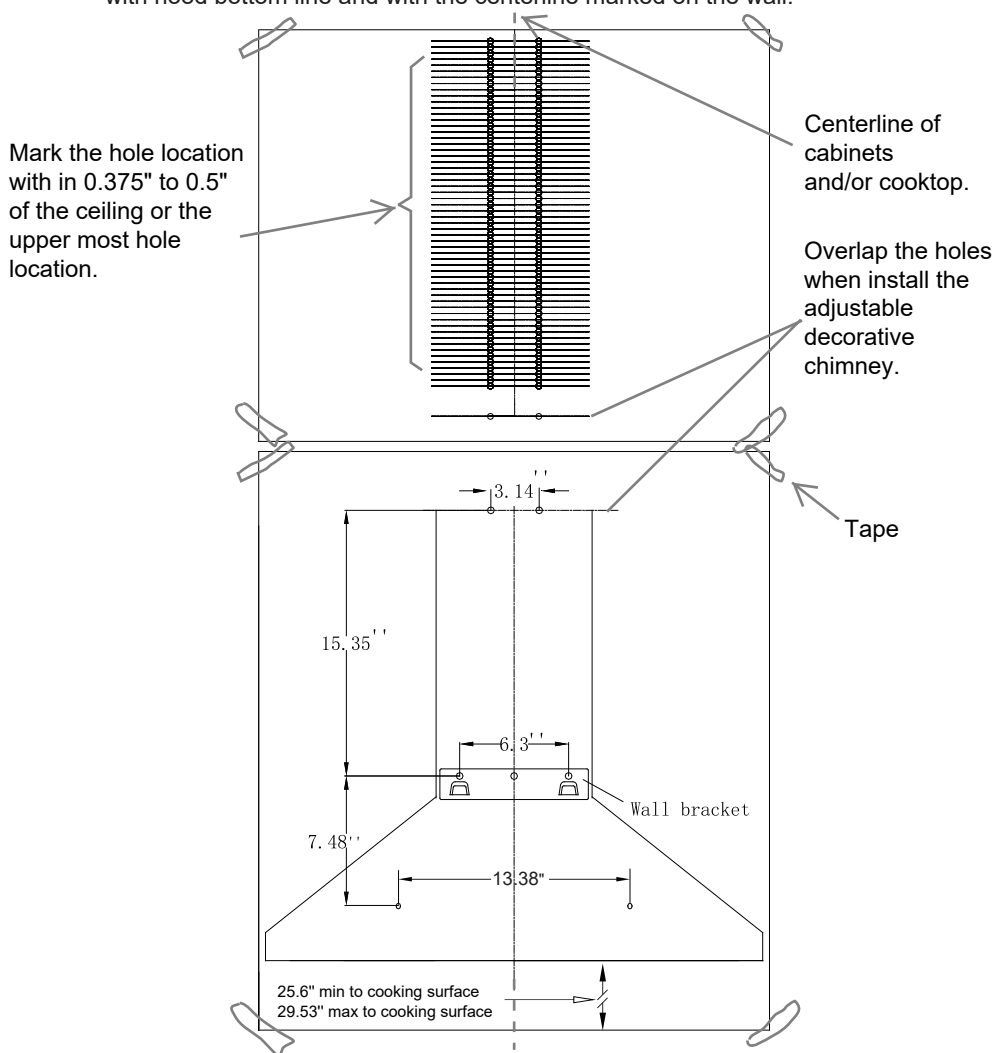

NOTE: Ensure that horizontal lines are level prior to marking hole locations.

INSTALLATION

WALL DRILLING AND BRACKET FIXING

unit: inch

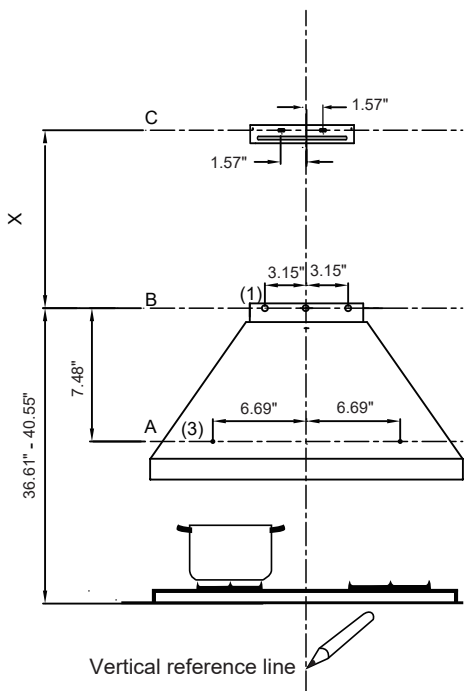

Chimney	X
15.75"	/
15.75"+11.81"	15.35"-24.41"

As a first step, proceed with the following drawings:

- A vertical line up to the ceiling or up to the upper limit, at the center of the area in which the hood is to be fitted.
- A horizontal line **B** at 36.61" - 40.55" above the cooker top.
- A horizontal line **C** at a **X** inch above the horizontal line **B**.
- A horizontal line **A** at a 7.48" below the horizontal line **B**.

Mark Points:

- Mark a point (1) on the horizontal line **B**, 3.15" to the vertical reference line.
- Repeat this operation on the other side and on the vertical reference line, checking that the three marks are leveled.
- Mark a point (2) on the horizontal line **C**, 1.57" to the vertical reference line.
- Repeat this operation on the other side, checking that the two marks are leveled.
- Mark a point (3) on the horizontal line **A**, 6.69" to the vertical reference line.
- Repeat this operation on the other side, checking that the two marks are leveled.

Fix the brackets :

- Drill holes at the marked points with a 3/8" drill bit.
- Insert the Wall Plugs 11 into the holes.
- Fix the hood fixing bracket **20** with 3 screws **10** (0.2" x 1.97") at the horizontal line **B**.
- Fix a Chimney fixing bracket **21** with 2 screws **10** (0.2" x 1.97") at the horizontal line **C**.

Hang and Mount the Vent Hood:

- Hang the vent hood onto fixing bracket 20
- Level the hood, and insert 2 long screws (10) into bracket 21 at level B
- Insert 2 long screws (10) into the hood at level A

➡ IMPORTANT

- The vent hood should be lifted and installed by 2 people to prevent injuries and potential damage

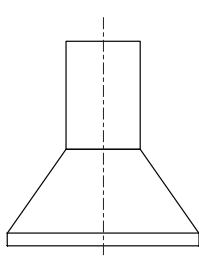

Right

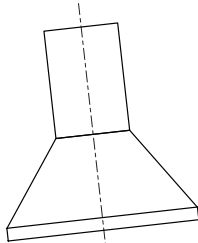

Wrong

Pre-Assemble the Upper Chimney Cover :

- Remove the protective foil from the Upper Decorative Chimney (2.2)
- Slide the Upper Decorative Chimney trim (2.2) into the Lower Decorative Chimney trim

Install Duct and Insert Plug:

- Install 6" duct over the flange on the fan body
- Use 2" wide metal tape to make an air tight seal between the duct and the fan body
- Install a clamp to secure the ductwork securely
- Remove Carbon Filters if installed
- Insert the plug into a properly grounded outlet

Assemble the Lower Chimney Cover:

- Slide the Lower Decorative Chimney trim (2.1) over the fan body.
- Ensure that the Decorative trim is pressed down to line up the lower mounting holes (A)
- Slightly lift the Upper Decorative Chimney cover
- Insert 2 short sheet metal screws (12) in the lower holes
- Place Chimney mounting bracket (21) at the top of the Lower Decorative Chimney (2.1), and insert 2 short sheet metal screws (12) into the outer most holes on the bracket at location B

⚠ WARNING

Electrical Shock Hazard

- This unit must be grounded. This appliance is equipped with a cord having a grounding wire with a grounding plug. The plug must be plugged into an outlet that is properly installed and grounded.
- Do not use an extension cord. If the power supply cord is too short, have a qualified electrician install an outlet near the appliance.

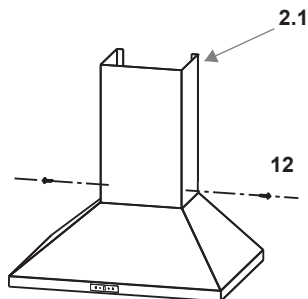

Install Upper Decorative Chimney :

- Install Chimney mounting bracket (21) at holes previously marked on level D.
- Slide the upper decorative chimney 2.2 up to the horizontal line D.
- Insert 2 small sheet metal screws into the sides of the bracket to secure the Upper Decorative Chimney.

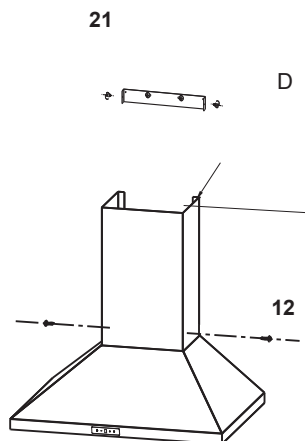

- Fix the upper chimney onto the bracket 21 with 2 screws 12 (0.17" x 0.37") supplied with the hood.

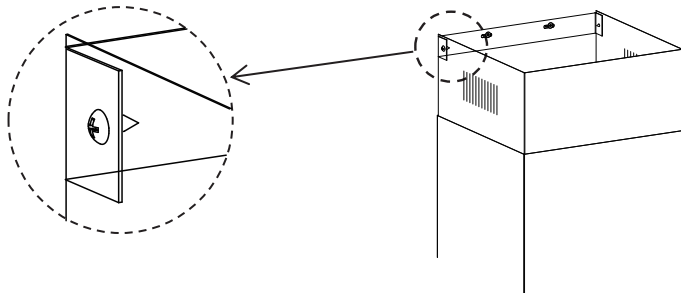





B. Non-Vented / Recirculation Installation

Recirculation Mode:

- Install Carbon Filters.
- Install deflector according to your installation environment.



Button	Function	Remarks	
	Turns the lighting system on or off.	Button on.	
—	Reduce the fan speed.	When " ⏻ " + " — " are on.	
	Display fan gear "1、 2、 3".	When the fan is running.	
	Display "0".	Delayed shutdown mode, or standby mode.	
+	Increase the fan speed.	When " ⏻ " + " + " are on.	
	Turn the hood ON.	When " ⏻ " is off.	
	Automatic shutdown after 3 minutes.	When " ⏻ " is on.	
	Turn the hood OFF.	When " ⏻ " is flashing.	
	Turn the machine and Lights ON.	When " ⏻ " is off.	Height between palm and switch board 10-15cm
	Change the motor speed circularly (1—2—3—1—2—3).	When " ⏻ " is on.	
	Enter delayed shutdown mode(Automatic shutdown after 3 minutes).	When " ⏻ " is on.	
	Turn the machine and Lights OFF.	When " ⏻ " is flashing.	

MAINTENANCE

GREASE FILTERS

CLEANING METAL SELF-SUPPORTING GREASE FILTERS

- The filters must be cleaned frequently and can be washed in a dishwasher or a hot detergent solution.
- Depress the latch to remove the filters.
- Avoid bending the filters when washing, and allow the filters to completely dry before reinstalling (The color of the filter surface may change throughout the time but this has no influence to the filter efficiency).
- When reinstalling the filter ensure the release latches are facing down, and are securely in place.

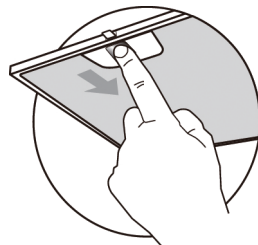

WARNING

Do not operate your cooktop when the filters are not installed into the vent hood.

ACTIVATED CHARCOAL FILTER (RECIRCULATION VERSION)

These filters are not washable and cannot be regenerated, and must be replaced approximately every 4 months of operation, or more frequently with heavy usage.

REPLACING THE ACTIVATED CHARCOAL FILTER

- Remove the metal grease filters
- Remove the saturated activated charcoal filter.
- Fit the new filters.
- Replace the metal grease filters.
- The service part number: 12173000001200.

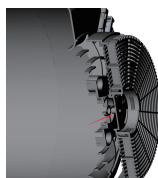
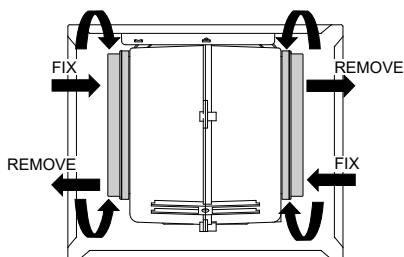
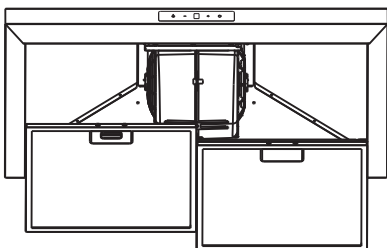



LIGHTING

LIGHT REPLACEMENT

Replacing the light modules

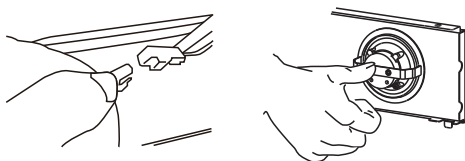
- The entire light module must be replaced.
- Before changing the light module(s), unplug the appliance or switch off the circuit breaker in the fuse box.
- Remove the grease filter .
- Disconnect the terminal of LED light.
- Press LED light on the back of the front plate, take the LED light out.
- Replace the lamp.



	Max Power	Voltage	Picture	Service Number
Round/ Diameter:2.76"	1.5W	DC 12 V		17473000000136

Reinstalling the LED Light Module

- Press LED light on the front of front plate, install the LED light on the front plate.
- Connect the terminal of LED light and light leads.
- Reinstall the grease filter.



1 YEAR LIMITED WARRANTY

This is the only express warranty for this product and is in lieu of any other warranty or condition.

This product is warranted to be free from defects in material and workmanship for a period of one (1) year from the date of original purchase. During this period, your exclusive remedy is repair or replacement of this product or any component found to be defective, at our option; however, you are responsible for all costs associated with returning the product to us and our returning the product or component under this warranty to you. If the product or component is no longer available, we will replace with a similar one of equal or greater value.

This warranty does not cover wear from normal use or operation that does not comply with the instruction manual or damages to the product resulting from accident, alteration, abuse, or misuse. This warranty extends only to the original consumer purchaser or gift recipient. Keep the original sales receipt, as proof of purchase is required to make a warranty claim. This warranty is void if product is used for other than single-family household use or subjected to any voltage and waveform other than as specified on the label.

We exclude all claims for special, incidental, and consequential damages by breach of express or implied warranty. All liability is limited to amount of the purchase price. Every implied warranty, including any statutory warranty or condition of merchantability or fitness for particular purpose, is disclaimed except to the extent prohibited by law, in which case such warranty or condition is limited to the duration of this written warranty.

This warranty gives you specific legal rights. You may have other legal rights that vary depending on where you live. Some states or provinces do not allow limitations on implied warranties or special, incidental consequential damages, so the foregoing limitations may not apply to you.

Customer Service:

Phone: 1-866-646-4332

