

Comfee

Electric Pressure Cooker

Instruction Manual

CPC60114MBSS

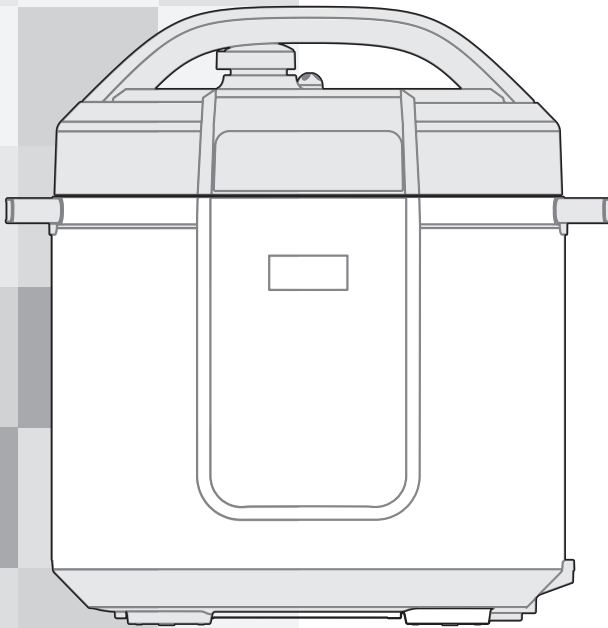

IMPORTANT NOTE: Please read the manual carefully before operating your product. Retain it for future reference. (Picture are for reference only, atual product may differ from picture shown)

CONTENT

IMPORTANT SAFEGUARDS	1
PARTS AND COMPONENTS	4
TECHNICAL DATE OF THE PRODUCT	4
QUICK START DUIDE	5
OPERATION INSTRUCTIONS	10
CLEANING AND MAINTENANCE	13
TROUBLESHOOTING	19
SERVICE AND SUPPORT	21

IMPORTANT SAFEGUARDS

CAUTION

- READ ALL INSTRUCTIONS.
- Do not touch hot surfaces. Only use side handles or knobs for carrying or moving.
- To protect against electrical shock, do not immerse the power cord, plugs, or appliance in water or other liquid.
- Close supervision is necessary when the appliance is used by or near children.
- Unplug from outlet when not in use and before cleaning. Allow to cool before putting on or taking off parts.
- Do not operate any appliance with a damaged cord or plug, or after the appliance malfunctions or has been damaged in any manner. Return appliance to the nearest authorized service facility for examination, repair, or adjustment.
- The use of accessory attachments not recommended by the appliance manufacturer may cause injuries.
- For household use only. Do not use outdoors.
- Do not let power cord hang over edge of table or counter, or touch hot surfaces.
- Do not place the appliance on or near a hot gas or electric burner, or a heated oven;
- Extreme caution must be used when moving the appliance containing hot liquids.
- Always attach plug to appliance first, then plug cord into the wall outlet.

IMPORTANT SAFEGUARDS

- Be aware that certain foods, such as applesauce, cranberries, pearl barley, oatmeal or other cereals, split peas, noodles, macaroni, rhubarb, or spaghetti can foam, froth, and sputter, and clog the pressure release device (steam vent). These foods should not be cooked in a pressure cooker.
- When the normal operating pressure is reached, turn the heat down so all the liquid, which creates the steam, does not evaporate.
- To disconnect, turn appliance “off”, then remove plug from wall outlet.
- Do not use appliance for anything other than intended use.
- This appliance cooks under pressure. Improper use may result in scalding injury. Make certain unit is properly closed before operating. Please see the “Getting Started” section.
- Do not fill the appliance over 2/3 full. When cooking foods that expand during cooking such as rice or dried vegetables, do not fill the appliance over 1/2 full. Over filling may cause a risk of clogging the vent pipe and developing excess pressure. See the “Food Preparation/Pressure Cooking” section.
- Do not open the appliance until the appliance has cooled and all internal pressure has been released. If the float valve is still up and/or the lid is difficult to open, this indicates that the appliance is still pressurized – do not force it open. Any pressure in the appliance can be hazardous. Please see the “Getting Started” section for instructions to safely remove lid.

IMPORTANT SAFEGUARDS

- Always check the pressure release devices for clogging before use.
- Do not use this appliance for pressure frying with oil.
- To prevent risk of explosion and injury, replace only dynamic seal ring as recommended by the manufacturer. See Operating Instructions.
- Intended for countertop use only.
- **WARNING:** Spilled food can cause serious burns. Keep appliance and cord away from children. Never drape cord over edge of counter, never use outlet below counter, and never use with an extension cord.
- **CAUTION:** Risk of Electric Shock. Cook only in removable container.
- This appliance is not intended for deep frying foods. “This appliance has a polarized plug (one blade is wider than the other). To reduce the risk of electric shock, this plug is intended to fit into a polarized outlet only one way. If the plug does not fit fully into the outlet, reverse the plug. If it still does not fit, contact a qualified electrician. Do not attempt to modify the plug in any way.

WARNING

PLEASE SAVE THESE INSTRUCTIONS

PARTS AND COMPONENTS

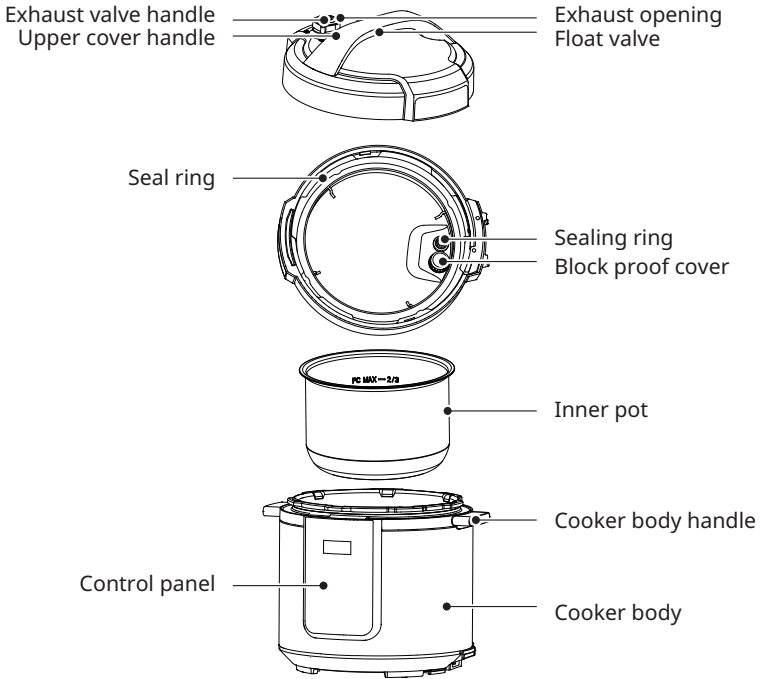

ACCESSORIES

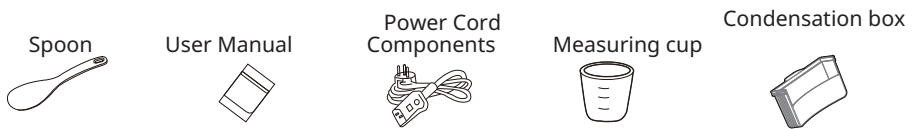

TECHNICAL DATA OF THE PRODUCT

Model	Capacity	Power Supply	Rated Power	Size of Inner Pot	Working Pressure	Keep Warm Temperature
CPC60114MBSS	6 Quart	120V~ 60Hz	1000W	8.66"	70kPa	140° F~176° F

QUICK START GUIDE

TIPS

- Please move the product with the handle of the cooker body;
- Please remove the water from the housing cover with cloth.

NOTE

- Exhaust valve: Pull out the exhaust valve from the lid. Clean the internal side of the exhaust valve and the exhaust valve and float valve of the lid with brush and cloth at least once a month.
- Sealing ring: Please remove oil and dirt from the sealing ring with detergent and brush.
- Water box: After cooking, the steam may stay in the water box of the external pot as water. Water in the box should be removed for avoiding bad odor, please clean it with clean cloth.

DISASSEMBLE AND INSTALL THE BLOCK PROOF COVER AND SEAL RING

Disassemble and install the block proof cover

1. Check if the seal ring and block proof cover are correctly installed in the upper cover before use each time.
2. After use, please clean the seal ring and around of block proof cover for avoiding jamming the cover, keep it clean to avoid bad odor.

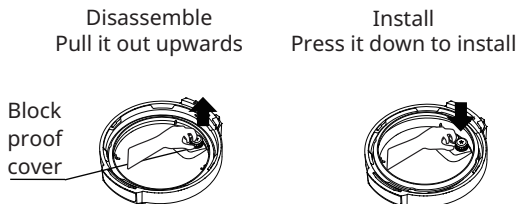

QUICK START GUIDE

Disassemble and install the seal ring

1. Please do not pull the seal ring, otherwise, the distorted seal ring may influence the seal and pressure effect.
2. Do not use the damaged seal ring, please replace it at the authorized repair office.

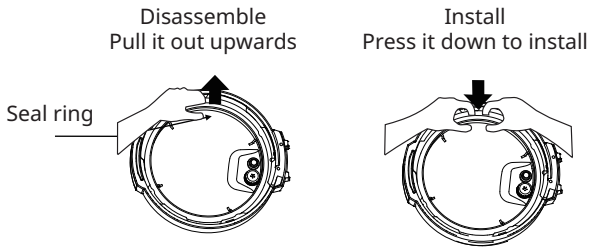

USE AND MAINTAIN THE INNER POT

1. Do not empty
It may cause yellowish and spotted inner pot or distorted bottom if it is empty for a long time.
2. Do not use it to store the acid, alkali and preserved foods for a long period
Although the inner pot has excellent anti-corrosion performance, it may cause corrosion of certain degree, the suggested time of keep warm shall not exceed 2h.
3. Keep it clean to prolong the service life
Do not immerse it in water for a long period.
Clean the inner pot with soap, mild detergent or warm water to remove dust, oil and dirt.
4. Do not use a metal shovel or other hard tool, otherwise it will damage the inner surface of pot.

QUICK START GUIDE

PREPARE FOR COOKING

1. Opening the lid correctly

- Hold the handle of upper cover, turn it anticlockwise for about 30° till the lid at unlock state, and then lift the upper cover.

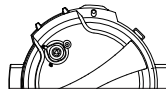

Unlock State

2 Check if the parts and accessories of lid are well installed

- Check if the floater valve and exhaust valve are jammed, confirm if the sealing ring and block proof cover are well installed.

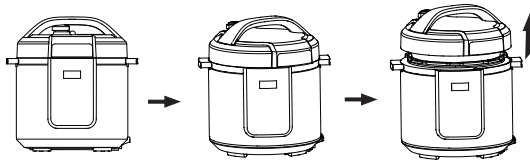

3. Take out the inner pot, put the foods and water into the inner pot

- The total amount of foods and water shall not exceed the Max marked on the inner pot.

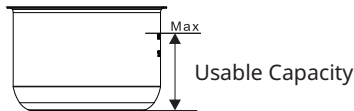

4. Put the inner pot into the cooker

- Wipe to clean the external surface of inner pot, foreign object and water are not allowed on the inner surface of electric pressure cooker;
- Turn the inner pot to left and right to ensure good contact with the heating plate.

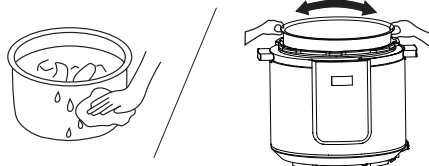

QUICK START GUIDE

5 Safely close the lid

- Before closing the lid, check if the sealing ring is well installed.
- Hold the handle of upper cover, aim the lid as “unlock state”, put the top cover horizontally on the cooker body, turn the upper cover clockwise for about 30° to the lock place as “Lock State”.

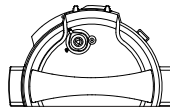

Lock State

6 Put the exhaust valve well

- When working, please turn the exhaust valve to the sealing place, which means the electric pressure cooker keeps at sealing state;
- For manual exhaust, please turn the exhaust valve handle to the exhaust place, the electric pressure cooker keeps at the exhaust state; when exhausting, do not keep the hands or face above the exhaust opening;

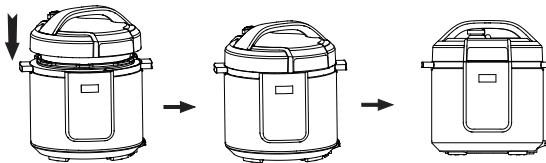

(Picture are for reference only, actual product may differ from picture shown)

- Check if the floater valve drops down before working (before heating, the floater valve is down).

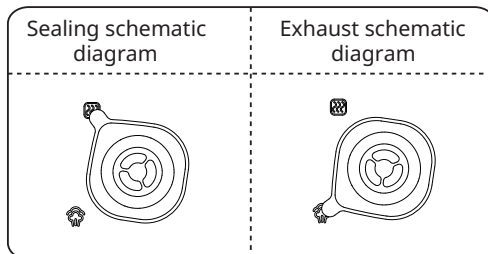

QUICK START GUIDE

GENERAL FUNCTION

1. Switch on If the buttons are inactive when use, please confirm if the lid is closed at the right place, the buttons are inactive if the lid is not closed correctly for product of this series.
2. After cooking, the cooker may automatically enter into the keep warm state. After cooking, the cooker may automatically enter into the keep warm state(Some funtion). and the indicator display "0H(0 hour), 1H(1 hour), 2H(2 hour)... "or " L0:00(0 min), L0:01(1 min)...."

TIPS

When the cooker is working, it is normal that it makes "cluck" sound, please set your heart at relax when use.

To cook a small amount of foods, the inner pot may possibly be lifted when opening the lid, please shake the lid to drop the inner pot in the cooker body and then remove the lid.

SAFELY OPEN THE LID

1. Cut off power supply or remove the power plug
2. Exhaust method
 - A. Quickly open the lid (For non-fluid foods)
Turn the exhaust valve to the exhaust place for exhausting, Some unit by pressing steam release button " " till the float valve drops down.
 - B. Generally open the lid
Keep the electric pressure cooker cool naturally till the float valve drops down.
3. Open the lid
Turn the upper cover anticlockwise with the left hand, turn it to the cover open limit place, lift the upper cover with the right hand to open the lid.
Do not open the lid before the pressure in the pot has been completely released, do not open the lid fiercely if it is difficult to open.
Do not pull out the exhaust valve when turning the exhaust valve.
After cooking fluid foods (porridge and soup), do not turn the exhaust valve or press the steam release button please cut off power supply to make it cool naturally till the float drops before opening the lid.

OPERATION INSTRUCTIONS

OPERATION PART

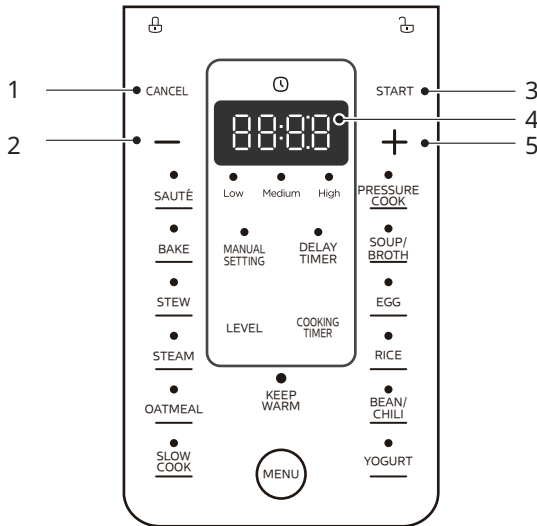

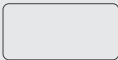
		Function description
1	CANCEL	• Cancel Button
2	-	• "-" Button
3	START	• Start Button
4		• Display Screen
5	+	• "+" Button

OPERATION INSTRUCTIONS

Function	Operation Guidelines
Cancel	<ul style="list-style-type: none"> Under any state, press "Cancel" button to cancel the current work state and return standby state. Press and hold the "Cancel" button for ten seconds to restore the default menu parameters.
Keep Warm	<ul style="list-style-type: none"> Under standby state, press "Keep Warm" button, the indicator light is on and the digital screen shows default working time. Press "Cooking Timer" button, then press "+" or "-" button to adjust the working time. Press "Start" button to enter into to enter into keep warm state. Enters into standby state when it finishes working.
Sauté	<ul style="list-style-type: none"> Under standby state, press "Menu" button, the indicator light is on and the digital screen shows default working time. Press "Cooking Timer" button, then press "+" or "-" button to adjust the working time. Press "Start" button to enter into cooking state. Starts countdown and enters to standby state when it finishes working.
Bake	<ul style="list-style-type: none"> Under standby state, press "Menu" button, the indicator light is on and the digital screen shows default working time. Press "Cooking Timer" button, then press "+" or "-" button to adjust the working time. Press "Start" button to enter into cooking state. Starts countdown and enters to standby state when it finishes working.
Slow Cook/ Yogurt	<ul style="list-style-type: none"> Under standby state, press the function button, the indicator light is on and the digital screen shows default working time. Press "Cooking Timer" button, then press "+" or "-" button to adjust the working time. Press "Start" button to enter into cooking state. The digital screen starts countdown and the unit enters to keep warm (Slow Cook) or standby state (Yogurt) when it finishes working.

OPERATION INSTRUCTIONS

Function	Operation Guidelines
Stew/ Soup/Broth Steam/ Oatmeal/ Pressure Cook/ Egg Bean/Chili Rice/ Manual/ Setting	<ul style="list-style-type: none"> Under standby state, press "Menu" button, the indicator light is on and the digital screen shows default working time. Press "Cooking Timer" button, then press "+" or "-" button to adjust the working time. Press "Start" button to enter into cooking state. The digital screen starts countdown as soon as the pressure rise to working pressure. Enters into keep warm when it finishes working.
Delay Timer	<ul style="list-style-type: none"> Delay cooking: Before the program start, press "Delay Timer " button. The screen shows the preset beginning time. Press "Cooking Timer" button, then press "+" or "-" button to adjust the delay time. Then press "Delay Timer" button to change Hour and minute. Press "Start" button, the unit starts delay time countdown. When it countdown to the end, the program starts working. Note: Yogurt、 Sauté、 Bake、 Keep Warm function cannot set the delay timer.
Level	<ul style="list-style-type: none"> Before the program start, you can press "Level" button to change the food flavor for "Low" or "Medium" or "High".

CLEANING AND MAINTENANCE

DAILY CHECK AND MAINTENANCE

For use the product safely with a longer service life, please carefully check and maintain it.

If followings occur	Solutions
<ul style="list-style-type: none">• Power cord and plug is expanded, deformation, damaged and its color is changed.• One part of the power cord and plug are hotter.• Power cord is flexible with discontinuous power supply.• The electric pressure cooker has abnormal heating and generates bad odor.• There's abnormal noise or vibration when supply power.	Stop using, and repair it by the authorized repair center.
<ul style="list-style-type: none">• There's dust or dirt on the plug or socket.	Remove the dust or dirt.

SAFETY PRECAUTIONS

To avoid personal injury and property loss, be sure to observe the following safety precautions.

- Meanings of the marks:

Means "Forbidden" items	General Forbid	Disassemble Forbidden	Wet hands Forbidden
	Contact Forbidden	Spray Water Forbidden	
Means "Mandatory" items	Must be executed	Remove the power plug	

- The danger caused by mistaken use if following warnings are neglected includes to two grades.



WARNING

It may possibly cause death or serious injury if the warning items are disobeyed.



CAUTION

It may cause physical injury or property damage if the caution items are disobeyed.

▲ WARNING

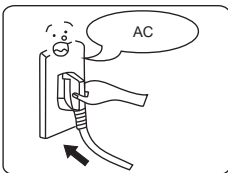

Use correct power outlet (Refer to the label)

- Failure to use correct electricity can cause fire or electric shock.
- Danger of fire if the bad socket is adopted.

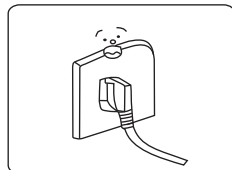

A socket shall be used alone

- A socket of more than 10A rated current with ground-ing wire shall be used alone;
- If shared with other electrical appliances, the socket may cause abnormal heat and result in fire.



⚠ WARNING

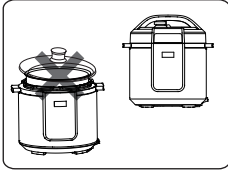

It is strictly prohibited to use other lid

- It is strictly prohibited to use other lid for heating, and in the (switching on) process, the use of non-original lid is not allowed.
- As this may cause electric shock or safety hazards.

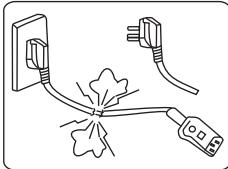

Stop using if the power cord is damaged

- Replace the damaged power cord with special soft cord or replace it with special assembly purchased from the manufacturer or authorized repair center.

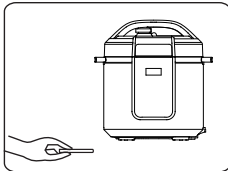

Do not put foreign objects

- It is prohibited to insert metal shavings, needles and other foreign matter in the gap.
- As this may cause electric shock or movement anomalies.

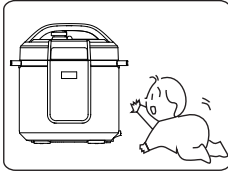

Place the appliance in a location out of reach of infants

- Place the appliance in a location out of reach of infants.
- To avoid electric shock and scald.

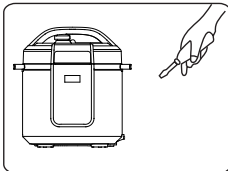

Modification is prohibited

- Modification or repair by non-professionals is prohibited.
- Violation may cause a fire or electric shock.
- Repair or replacement of parts shall be made in a designated service center.

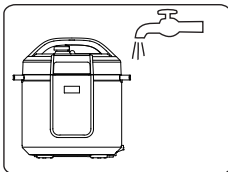

Products may not be immersed or sprinkled in water

- Doing so could cause electric shock and electrical short circuits.



⚠ WARNING

Warning on Opening the lid

- When the electric pressure cooker is not working, there isn't pressure in the pot, the float valve is down;
- When the electric pressure cooker is working, pressure in the cooker rises, float valve ascends; do not fiercely open the lid before the pressure has been completely released;
- If it is difficult to open the lid, please do not open it fiercely, otherwise, it may cause scalding or physical injury.

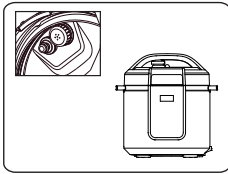

Check periodically

- Be sure to check periodically the block proof cover and exhaust valve core to make sure that they are not be blocked;
- Do not cover the exhaust valve with heavy object or replace it with other object.



⚠ CAUTION

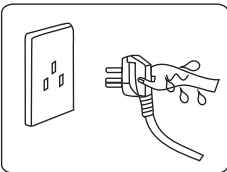

- Never pull the plug with a wet hand
- To avoid electric shock.

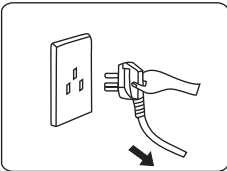

- When pulling the plug, you must pinch the plug
- When pulling the plug, you must pinch the plug;
 - Do not pull the power cord, otherwise it will damage the cord, causing electric shock and short circuit.

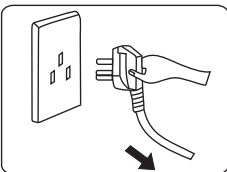

- Unplugging when not in use
- Otherwise, it may produce leakage, fire or failure.



⚠ CAUTION

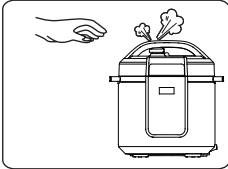

In working, never move your hands to close to the exhaust port.

- In cooking process, never move your hands to close to the exhaust port to avoid burns.
- During cooking, do not cover the vent with a cloth and other items.

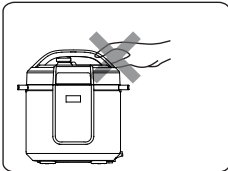

When the cooker is working, please do not touch the lid

- When the cooker is working, lid has high temperature, do not touch it;
- Otherwise, it may possibly cause scalding.

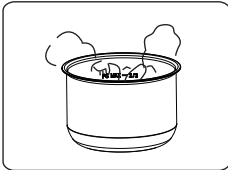

The total amount of food and water can not exceed Max scale

- The total amount of food and water can not exceed Max scale, otherwise food may be cooked unfamiliar, or cause malfunction.

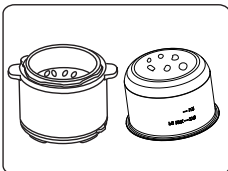

Do not use a pot other than the dedicated pot

- When there is foreign object on the bottom of pot and heating plate surface, remove the foreign object before use.
- Otherwise, it may cause overheating and work abnormalities etc.

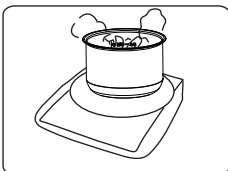

Do not put the inner pot on other appliance for heating

- In order to avoid deformation or fault.
- Please use the special inner pot.

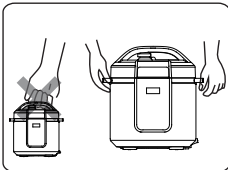

When moving the product, please hold the handle of cooker body

- When moving the product, do not directly hold the handle of lid for avoiding lid dropping.



CAUTION

Do not use in the following locations

- Do not use in unstable locations;
- Do not use in locations near water and fire;
- Do not use near walls and furniture;
- Do not use in locations exposed to direct sunlight and oil splatter.
- Do not approach the stove for avoiding fire.



ENVIRONMENT FOR STORING THE PRODUCT

- Periodically clean the cooker and remove oil and dirt if it is stored on the table.
- Put the electric pressure cooker 30cm away from other kitchen appliances.

CLEAN AFTER USE

1. Clean after each use.
2. Before cleaning and maintenance, please unplug the power cord until the product cools.
3. Remove the lid and inner pot, clean with detergent first, then rinse well with water, and wipe dry with a soft cloth.
4. Clean the internal side of the lid with water, the seal ring, block proof cover, exhaust valve core and float valve can be removed for washing, timely and correctly install them after washing, and then dry the internal side of lid with cloth.
5. Wipe clean the cooker body with a rag, and it is prohibited to soak the cooker body in water or spray water to it.

TROUBLESHOOTING

Operation of your appliance can lead to errors and malfunctions. The following tables contain possible causes and notes for resolving an error message or malfunction. It is recommended to read the tables carefully below in order to save your time and money that may cost for calling to the service center.

Problem	Reason	Solution
Difficult to close the lid	Sealing ring not installed properly	Position the sealing ring well
	The floater valve clamps the push rod	Lightly push the push rod
Difficult to open the lid	Float valve in the popped-up position	Press the float valve lightly with a chopstick.
	Pressure exists inside the cooker	Open the lid after the pressure is completely released.
Steam leaks from the lid	Sealing ring installed improperly	Install the sealing ring as required
	Food debris attached to the sealing ring	Clean the sealing ring
	Sealing ring damaged	Replace the sealing ring
	The lid is not closed correctly	Close the lid correctly
Steam leaks from float valve	Food debris on the float valve gasket	Clean the float valve gasket
	Float valve gasket worn-out	Replace the float valve gasket
Float valve unable to rise	Too little food and water in inner pot	Add water and food according to the recipe
	Steam leaks from the lid or exhaust valve	Send to the service center for repair

TROUBLESHOOTING

Problem		Reason	Solution
Steam comes out from exhaust valve non-stop		Exhaust valve not in sealing position	Turn the exhaust valve to the sealing position
		Pressure control fails	Send to the service center for repair
Power indicator doesn't light on		Power socket bad contact	Please check the power socket
All indicators flas	Display screen displays E1	Bottom sensor fault	Send to the service center for repair
	Display screen displays E2		
	Display screen displays C1	High temperature since there isn't water in the inner pot	Add water according to the requirement
		High temperature since there isn't water in the inner pot	Put the inner pot correctly
	Display screen displays E8	Pressure switch fault	Send to the service center for repair
Rice half cooked or too hard		Too little water	Add water accordingly
		Lid opened prematurely	After cooking cycle completes, leave the lid on for 5 more minutes.
Rice too soft		Too much water	Reduce water accordingly

—If the fault is not removed after above check, please contact our authorized service center for repair.

SERVICE AND SUPPORT

1 YEAR LIMITED WARRANTY

This is the only express warranty for this product and is in lieu of any other warranty or condition. This product is warranted to be free from defects in material and workmanship for a period of one (1) year from the date of original purchase. During this period, your exclusive remedy is repair or replacement of this product or any component found to be defective, at our option; however, you are responsible for all costs associated with returning the product to us and our returning the product or component under this warranty to you. If the product or component is no longer available, we will replace with a similar one of equal or greater value.

This warranty does not cover wear from normal use, and operation doesn't conform with the instruction manuals, or damages to the product resulting from accident, alteration, abuse, or misuse. This warranty extends only to the original consumer purchaser or gift recipient. Keep the original sales receipt, as proof of purchase is required to make a warranty claim. This warranty is void if products is used for other than single-family household use or subjected to any voltage and waveform other than as specified on the label.

We exclude all claims for special, incidental, and consequential damages by breach of express or implied warranty. All liability is limited to amount of the purchase price. Every implied warranty, including any statutory warranty or condition of merchant-ability or fitness for particular purpose, is disclaimed except to the extent prohibited by law, in which case such warranty or condition is limited to the duration of this written warranty.

This warranty gives you specific legal rights. You may have other legal rights that vary depending on where you live. Some states or provinces do not allow limitations on implied warranties or special, incidental consequential damages, so the foregoing limitations may not apply to you. Please note that failure to complete and submit this form does not diminish your warranty

comfee'
... is how i feel !