

**Comfee**

# RICE COOKER

## User Manual

CRD20L1B1BPH

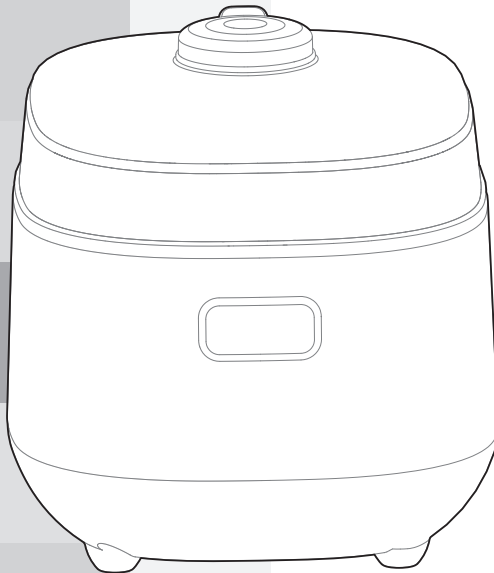

**IMPORTANT NOTE:** For your safety and continued enjoyment of this product, always read the user manual carefully before using.

# **CONTENT**

IMPORTANT SAFEGUARDS .....	1
PRODUCT OVERVIEW .....	4
SPECIFICATIONS .....	5
QUICK START GUIDE .....	6
OPERATION INSTRUCTIONS .....	8
CLEANING AND MAINTENANCE .....	19
TROUBLESHOOTING .....	21
SERVICE AND SUPPORT .....	23

# **IMPORTANT SAFEGUARDS**

## **CAUTION**

- When using electrical appliances, basic safety precautions should always be followed including the following:
- Read all instructions.
- Do not touch hot surfaces. Use handles or knobs.
- To protect against electrical shock, do not immerse cord, plugs, or appliance in water or other liquid.
- Close supervision is necessary when any appliance is used by or near children.
- Unplug from outlet when not in use and before cleaning. Allow to cool before putting on or taking off parts.
- Do not operate any appliance with a damaged cord or plug or after the appliance malfunctions or has been damaged in any manner. Return appliance to the nearest authorized service facility for examination, repair, or adjustment.
- The use of accessory attachments not recommended by the appliance manufacturer may cause injuries.
- Do not use outdoors. HOUSEHOLD USE ONLY.
- Do not let cord hang over edge of table or counter, or touch hot surfaces.
- Do not place on or near a hot gas or electric burner, or in a heated oven.
- Extreme caution must be used when moving an appliance containing hot oil or other hot liquids.

## **IMPORTANT SAFEGUARDS**

- Always attach plug to appliance first, then plug cord into the wall outlet. To disconnect, turn any control to “off”, then remove plug from wall outlet.
- Do not use appliance for purposes other than its intended use.
- CAUTION: Risk of Electric Shock. Cook only in removable container.
- Intended for countertop use only.
- Do not solely use the handle to carry the rice cooker, appliance must be supported from the bottom when moved.
- A short power-supply cord is used to reduce the risk resulting from it being grabbed by children, becoming entangled in, or tripping over a longer cord.

## **IMPORTANT SAFEGUARDS**

### **WARNING**

- **WARNING:** Spilled food can cause serious burns. Keep appliance and cord away from children. Never drape cord over edge of counter, never use outlet below counter, and never use with an extension cord. Cord:
- **DO NOT IMMERSE IN WATER.**

**HOUSEHOLD USE ONLY  
SAVE THESE INSTRUCTIONS**

# PRODUCT OVERVIEW

## COMPONENT NAME

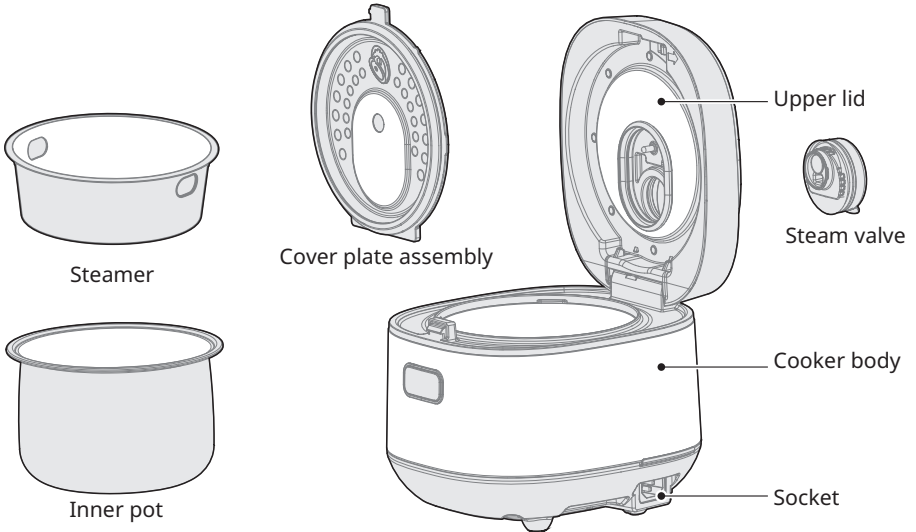

## PARTS LIST



Rice spoon × 1



Soup spoon × 1



Measurement cup × 1



Power cord × 1



Manual × 1

# SPECIFICATIONS

## TECHNICAL DATA OF THE PRODUCT

Product Model	Voltage	Frequency	Power	Capacity
CRD20L1B1BPH	120V~	60Hz	350W	2L

### ● NOTE

All the pictures in this manual are for explanation purpose only. Any discrepancy between the real object and the illustration in the drawing shall be subject to the real subject. Remove the accessories from the packaging bag before installation.

# QUICK START GUIDE

## Reservation

**For example: Make an appointment to finish cooking in 8 hours.**

1. Prepare rice and water  
Place the rinsed rice into the inner pot and choose the appropriate water level according to the rice amount.

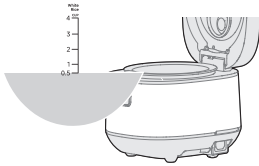

2. After closing the lid, select Quick Rice or other functions by using the Quick Rice or MENU button.



OR



3. Set the timer for cooking completion  
Press the "DELAY" button, the Time Display flashes, and then press the button "DELAY" again to adjust the displayed reservation time.



8:00

4. Start cooking  
Press the "START" button, the cooking will be finished at the appointed time.



## Gentle Reminder:

Display status refers to actual product.

5. Cancel cooking  
Pressing the "KEEP WARM/CANCEL" button can cancel the selected cooking function.





# **QUICK START GUIDE**

**Gentle Reminder:**

1. The time displayed under pre-set timer mode is the length of time from the start to the completion of cooking;
2. To avoid an unpleasant odor in the rice, it is advisable not to set the pre-set timer for more than 12 hours."
3. The pre-set time of the selected cooking function's should not be less than the cooking time. For example, if the reservation time for "SOUP" is less than 2 hours then cooking will start immediately because the cooking time is pre-set as 2 hours.

# OPERATION INSTRUCTIONS

## OPERATION PART

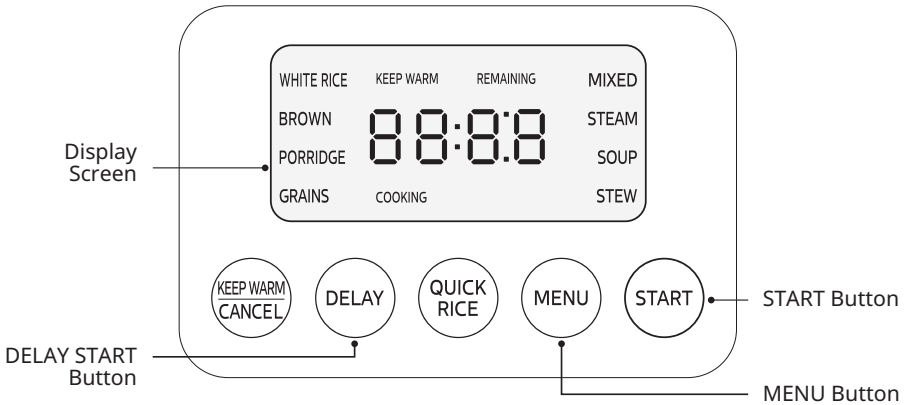

## INSTRUCTIONS FOR USE

### Rice-water Ratio

1. Use the measuring cup provided with the product to measure the rice.



1 cup of rice can cook about 2 bowls of rice (the diameter of the bowl rim is about 11.5cm)



Correct  
The rice should be level with the rim of the cup

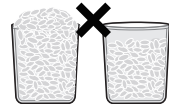

If it is higher or lower than the rim, the water level will not be accurately controlled

### NOTE

1. A 2-liter conventional rice cooker can cook up to 4 cups of rice, otherwise it may cause overflow or undercooked rice;
2. 11.5cm is the size of a regular household bowl.

# **OPERATION INSTRUCTIONS**

## **QUICK RICE COOKING STEPS**

1. Measure and wash rice  
Use the measuring cup provided with the product to measure the rice and rinse the rice thoroughly.
2. Add water  
Add water according to the rice water level in the picture on the right (taking long grain rice as an example)
3. Cook  
Close the rice cooker lid and press the "QUICK RICE" button.  
Select the "QUICK RICE" function and press the "START" button to enter the cooking state. After about 30 minutes, the cooking is completed and it automatically enters the keep-warm mode.

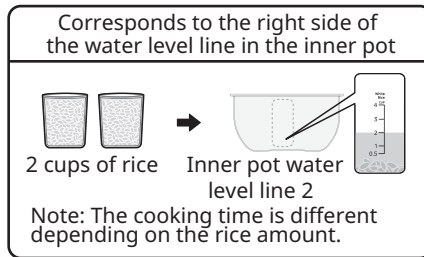

# OPERATION INSTRUCTIONS

## INSTRUCTIONS FOR USE

### Rice-water Ratio

#### 1. Rice measuring method

1 measuring cup of rice can be cooked into 2 bowls of steamed rice, and the diameter of the bowl is about 11.5 cm.

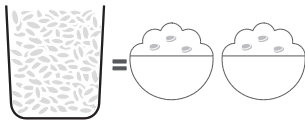

#### 2. Put in the rice and water

Take cooking 2 cups of rice as an example, put the washed rice into the inner pot and add water to the corresponding scale line 2 (the water level line shall be subject to the actual object).

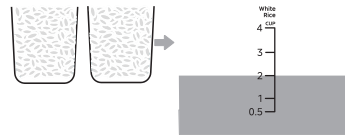

## FUNCTION DESCRIPTION

(For specific functions, please refer to the actual panel for selective reference)

### QUICK RICE

- Put the washed rice into the inner pot, refer to the rice-water ratio and inject the water according to the White Rice water level line, or increase or decrease the water quantity according to personal preference.
- Close the cover and select the "QUICK RICE" cooking function (The default time is 30 minutes, and the cooking time varies depending on the amount of rice and water added).

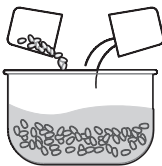

- Press the "MENU" button to select the "QUICK RICE" function, and press the "START" button to enter the cooking state.



### NOTE

- The water shall not exceed the highest scale line.
- For example, the rice-water ratio for bean or cereal quick rice can be adjusted according to the actual situation.

# OPERATION INSTRUCTIONS

## BROWN

### 1. Measure and wash rice

Measure the rice in the measuring cup supplied with the product and wash the rice well.

### 2. Add water

Add water with reference to the water level of the RICE on the right.

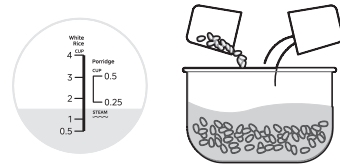

### NOTE

The cooking time will vary depending on the amount of rice.

### 3. Cooking

Close the rice cooker lid and press the "MENU" button. Select the "BROWN" function and press the "START" button to enter the cooking state. After about 1 hour and 20 minutes, you will hear a di-beep, which indicates that cooking is finished, and the cooker will automatically enter the keep warm mode.

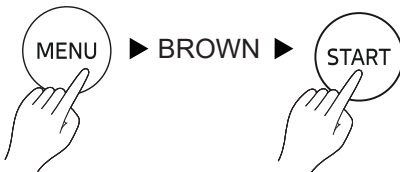

### Tips

- "BROWN" is cooked for approximately 1 hour and 20 minutes.
- Soak for two hours before using the function "BROWN".

# OPERATION INSTRUCTIONS

## PORRIDGE

### 1. Measure and wash rice

Measure the rice in the measuring cup supplied with the product and wash the rice well.

### 2. Add water

Add water with reference to the water level of the Porridge on the right.

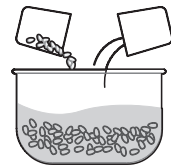
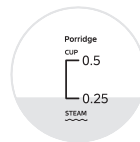

### 3. Cooking

Close the rice cooker lid and press the "MENU" button. Select the "PORRIDGE" function and press the "START" button to enter the cooking state. (Default time is 1 hour and 30 minutes) After cooking, it automatically enters the keep-warm mode.



## ● NOTE

- The water shall not exceed the highest scale line.

# OPERATION INSTRUCTIONS

## GRAINS

### 1. Measure and wash rice

Measure the rice in the measuring cup supplied with the product and wash the rice well.

### 2. Add water

Add water with reference to the water level of the RICE on the right.

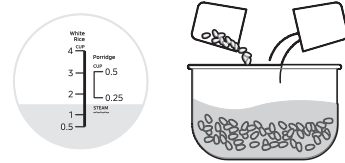

### NOTE

The cooking time will vary depending on the amount of rice.

### 3. Cooking

Close the rice cooker lid and press the "MENU" button. Select the "GRAINS" function and press the "START" button to enter the cooking state. After about 1 hour and 10 minutes, you will hear a di-beep, which indicates that cooking is finished, and the cooker will automatically enter the KEEP WARM mode.



### Tips

- "GRAINS" is cooked for approximately 1 hour and 10 minutes.
- Soak for two hours before using the function "GRAINS".

# OPERATION INSTRUCTIONS

## MIXED

### 1. Measure and wash rice

Measure the rice in the measuring cup supplied with the product and wash the rice well.

Mix the ingredients (such as spare ribs) and the appropriate amount of ingredients (such as scallions, ginger, garlic, soy sauce), and marinate the stirred ingredients for a little time according to personal taste.

### 2. Add water

Add water with reference to the water level of the RICE on the right.

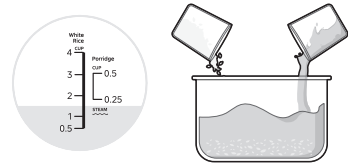

### NOTE

- 1.The cooking time will vary depending on the amount of rice.
- 2.When adding rice, the maximum amount should not exceed 2 cups.
- 3.Mixed rice needs to add cooking oil, otherwise the cooking effect may not be good.

### 3. Cooking

Close the lid and press the "MENU" button. Select the "MIXED" function and press the "START" button to enter the cooking state. After cooking for about 20 minutes, when the sound starts, spread the marinated ingredients on the rice, close the lid of the pot, and wait patiently until the cooking is over. After about 40 minutes, you will hear a di-beep, which indicates that cooking is finished, and the cooker will automatically enter the keep warm mode.





# OPERATION INSTRUCTIONS

## STEAM

### 1. Add water

Add water with reference to the STEAM water level.



### 2. Cook

Put the food in the steamer, then put the steamer into the inner pot, close the lid, press the MENU button and select STEAM (30 minutes by default), and finally press the "START" button and the cooker will enter the cooking state. When the cooking is finished, you will hear five beeps, and the cooker automatically enters into the KEEP WARM mode.

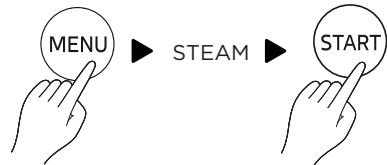

## SOUP

### 1. Prepare the ingredients

Wash the ingredients, cut them into pieces and put in the inner pot.

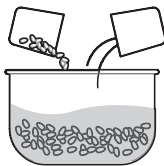

### 2. Add water

Add water according to personal preference, not exceeding the highest scale line.

3. Press the "MENU" button to select the "SOUP" function, and press the "START" button to enter the cooking state. (Cooking time is approximately 2 hours)

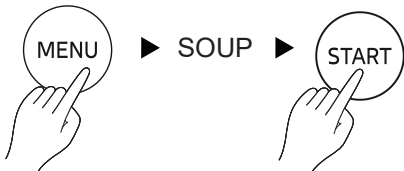

## NOTE

1. The water shall not exceed the highest scale line.

# OPERATION INSTRUCTIONS

## STEW

### 1. Prepare the ingredients

Wash the ingredients (ribs, corn, carrots), cut into small pieces and place in the inner pot.

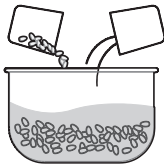

### 2. Add water

Add water according to personal preference, not exceeding the highest scale line.

3. Press the "MENU" button to select the "STEW" function, and press the "START" button to enter the cooking state.  
(Cooking time is approximately 2 hours)



# **OPERATION INSTRUCTIONS**

## **KEEP WARM/CANCEL**

1. During the cooking process, press the KEEP WARM/CANCEL button to cancel the cooking process and enter standby mode.

### **Gentle Reminder:**

1. After cooking, it will automatically trigger the heat preservation function;
2. During the process of warm keeping, the product will be heated to maintain the temperature above 149 degrees Fahrenheit;
3. The product can keep warm for as long as 24-hour;
4. In order to maintain the food taste and appearance, the heat preservation time is suggested within 5 hours.

# OPERATION INSTRUCTIONS

## THE USE OF WATER LEVEL LINES

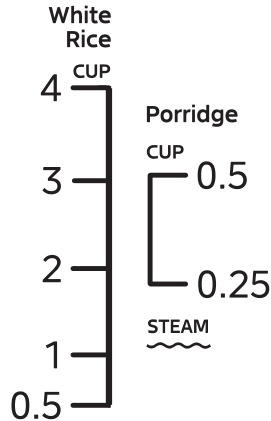

Rice: When adding water, for QUICK RICE, BROWN, the water level line depends on the water level line scale of the rice.

Maximum rice amount	Minimum rice amount
4 cups	0.5 cup

Porridge: Refer to the Porridge water line when adding water.

Maximum rice amount	Minimum rice amount
0.5 cup	0.25 cup

# CLEANING AND MAINTENANCE

Please disconnect the power supply before cleaning and maintenance

## REMOVE THE COVER

Press the white button in the direction of the arrow to remove the cover. (the cover will tilt forward)

After cleaning and drying, reinstall it in place.

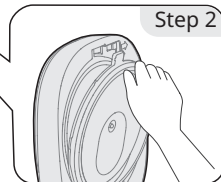
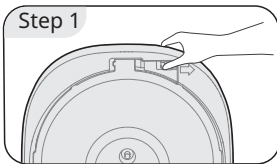

Grasp the cover and lift it out.

## REMOVE/INSTALL STEAM VALVE

Rotate "☞" to "△" as shown in the figure to disassemble.

Rotate "☞" to "△" as shown in the figure to install it in place.

Assemble in order  
Install clockwise

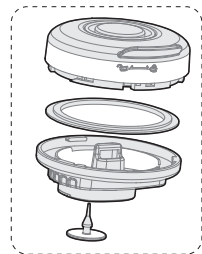
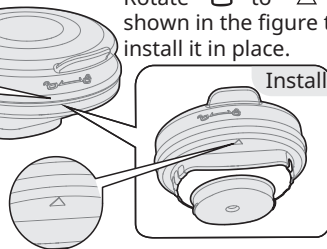
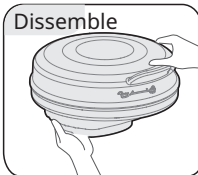

# CLEANING AND MAINTENANCE

---

## CLEAN COOKER BODY

Wipe with a clean soft cloth



- Note: After cleaning the inside of the cooker, be sure to dry it. Avoid turning on the power when there is water.

## CLEAN INNER POT/STEAMER

Soak in clean water for 10 minutes to allow the remaining rice to fully absorb water and then rinse

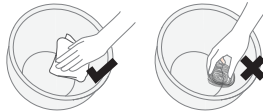

- Note: Do not use steel wool to clean the inner pot to avoid scratching the coating.

## DRY

After cleaning, dry the inner pot and steamer



# TROUBLESHOOTING

Operation of your appliance can lead to errors and malfunctions. The following tables contain possible causes and notes for resolving an error message or malfunction. It is recommended to read the tables carefully below in order to save your time and money that may cost for calling to the service center.

Abnormal situation	Possible reasons	Solutions
Too soft, too hard, too thick, too thin, not cooked, burnt rice, rice soup overflowing and insufficient boiling	<ul style="list-style-type: none"> <li>• Not adding water according to the water level line</li> <li>• Wrong selection of the function</li> <li>• There is foreign matter on heating plate</li> <li>• No proper installation of the steam valve</li> <li>• Deformation of inner pot</li> </ul>	<ul style="list-style-type: none"> <li>• Add water according to the water level line</li> <li>• Select the corresponding function</li> <li>• Remove foreign matters on the heating plate and cook again</li> <li>• Steam valve is installed in place</li> <li>• Contact customer replace the inner pot</li> </ul>
Peculiar smell, discolouration and dry during heat preservation	<ul style="list-style-type: none"> <li>• The sealing ring and the edge of the inner pot are mixed with foreign matters</li> <li>• Product air leakage</li> <li>• Too long warm preservation time</li> </ul>	<ul style="list-style-type: none"> <li>• Remove the foreign objects</li> <li>• Contact customer service center to replace the sealing ring</li> <li>• It is recommended that the heat preservation shall be within 5 hours</li> </ul>
Abnormal noise in the working process	<ul style="list-style-type: none"> <li>• Water on the inner pot has not been dried</li> <li>• The sound of the lid snapping shut when turning on or off the rice cooker</li> </ul>	<ul style="list-style-type: none"> <li>• Dry the water on the inner pot before using</li> <li>• Normal phenomenon</li> </ul>

# TROUBLESHOOTING

Indicat or state	Abnormal display	Possible Reason	Solutions
Light on	E1	Main thermistor (bottom sensor) open circuit	Pull out and re-connect the power cord, the display still shows same message, please send the cooker to your local after-sales service centre for maintenance.
Light on	E2	Main thermistor (bottom sensor) short circuit	
Light on	E5	Top lid sensor (handle thermistor) open circuit	
Light on	E6	Top lid sensor (handle thermistor) short circuit	
Light on	EU	Communication error	
Flash	EU	Communication error	



## **SERVICE AND SUPPORT**

### **1 YEAR LIMITED WARRANTY**

This is the only express warranty for this product and is in lieu of any other warranty or condition. This product is warranted to be free from defects in material and workmanship for a period of one (1) year from the date of original purchase. During this period, your exclusive remedy is repair or replacement of this product or any component found to be defective, at our option; however, you are responsible for all costs associated with returning the product to us and our returning the product or component under this warranty to you. If the product or component is no longer available, we will replace with a similar one of equal or greater value.

This warranty does not cover wear from normal use, and operation doesn't conformity with the instruction manuals, or damages to the product resulting from accident, alteration, abuse, or misuse. This warranty extends only to the original consumer purchaser or gift recipient. Keep the original sales receipt, as proof of purchase is required to make a warranty claim. This warranty is void if products is used for other than single-family household use or subjected to any voltage and waveform other than as specified on the label.

We exclude all claims for special, incidental, and consequential damages by breach of express or implied warranty. All liability is limited to amount of the purchase price. Every implied warranty, including any statutory warranty or condition of merchant-ability or fitness for particular purpose, is disclaimed except to the extent prohibited by law, in which case such warranty or condition is limited to the duration of this written warranty.

This warranty gives you specific legal rights. You may have other legal rights that vary depending on where you live. Some states or provinces do not allow limitations on implied warranties or special, incidental consequential damages, so the foregoing limitations may not apply to you. Please note that failure to complete and submit this form does not diminish your warranty

## **SERVICE AND SUPPORT**

In the Event of a warranty period claim, question, comments or if service is required for this product, please contact us at the following:

Customer Service Management Office:

Parsippany, NJ 07054

Toll Free: 1-866-646-4332

Amazon Store:

<https://www.amazon.com/comfee>

Tel: 866-646-4332

E-mail: [officialservice@comfeeappliance.com](mailto:officialservice@comfeeappliance.com)

Made in China



**comfee'**  
*... is how i feel !*