

Comfee[®]

Deluxe Bottom-Loading
Water Dispenser
with Self-Cleaning

Rated Power: 520W
Voltage: 115V
Frequency: 60Hz

USER MANUAL

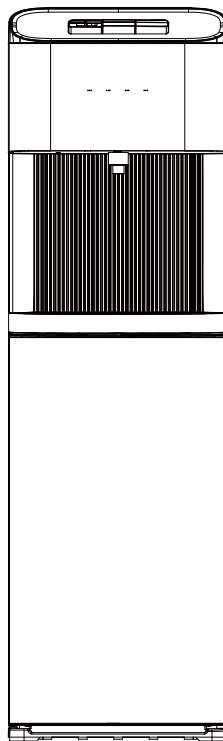

**Free 3 months
extension** of the
original limited warranty
period!* Simply text a
picture of your proof of
purchase to:

1-866-646-4332

*The warranty extension is for the
three months immediately following
the completion of the product's
original warranty period.

Model Numbers CWB41D4AST

Version A-0 12-2021

Table of Contents

page

Indicator Lights, Pushbuttons-----	1
Installation And Safety Precautions-----	2
Part Name -----	4
Operation Instructions -----	5
Deep Cleaning -----	8
Trouble Shooting -----	11
Warnings and Safety Precautions -----	12
Technical Parameters -----	13
1 Year limited warranty -----	13

WARNING

ELECTRICAL REQUIREMENTS

A 115 V, 60 Hz, AC only, 15 A or 20 A fused, grounded electrical supply is required. It is recommended that a separate circuit serving only your water dispenser be provided. Use an outlet that cannot be turned off by a switch. Do not use an extension cord.

Indicator Lights, Pushbuttons

INDICATOR LIGHTS:

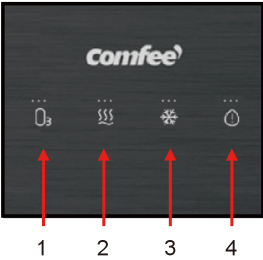

1	O ₃ LED
2	Heating LED
3	Cooling LED
4	Empty Bottel Reminder LED

PUSHBUTTONS:

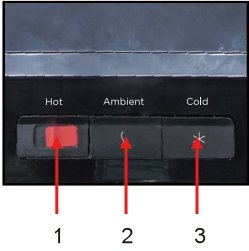

1	Hot Water Pushbutton
2	Room Temperature Pushbutton
3	Cold Water Pushbutton

Installation And Safety Precautions

LOCATE DISPENSER

Notice: Do NOT plug power cord into wall outlet until instructed.

1. Place dispenser upright. NOTE: If dispenser has been laid on its side, please allow it to remain upright for at least 24-hours prior to use.
2. Locate dispenser on a hard and level surface in a cool shaded location near a dedicated receptacle.
3. Position dispenser so the back is at least 4 inches from wall and there is at least 4 inches of clearance on both sides.

INSTALL SAFETY BRACKETS

⚠ WARNING To prevent the water dispenser from tipping, please install the enclosed safety bracket.

- 1-2. Loosen the screw of the left or right bottom angle just as the picture shown.
3. Use the screw to fix the bracket on the left or right bottom angle of the water dispenser.
4. Make a hole on the floor's or the desk's surface where the water dispenser will be installed.
5. Fix the bracket on the floor by screw tightly.
6. Tighten the screw.

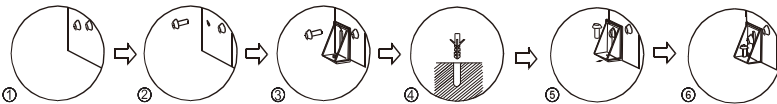
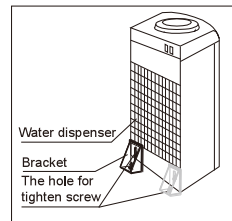

INSTALL DRIP TRAY & COVER

1. Remove drip tray and cover from protective packaging.
2. Slide drip tray assembly into position and secure.

INSTALL WATER BOTTLE

1. Open lower cabinet door.
2. Located inside the cabinet is the water bottle straw.
Carefully pull out the water bottle straw and place on front door hanger.
3. Clean the outside of the water bottle with a clean cloth.
4. Insert the water bottle straw into the water bottle.
5. Slide the collar down until it locks into place.
6. Press the head down until the tube hits the bottom of the bottle.
7. Slide the water bottle into the cabinet and close the door.
8. Water will not pump from water bottle until door is fully closed.

NOTE: To minimize mineral deposits which can clog lines and cause odors and off-tastes, use only high quality purified bottled water.

DO NOT USE TAP WATER TO REFILL WATER BOTTLE.

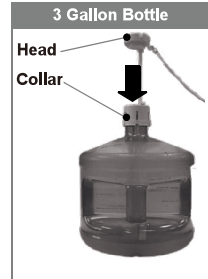

PLUG INTO A GROUNDED OUTLET

Plug dispenser into a dedicated GFCI outlet. At this time, the water pump will begin to move water from the bottle to the hot and cold tanks. It will take up to 4-minutes to fill the tanks for the first time. During this period, the pump will run continuously. This is normal.

NOTE: The dispenser is intended to be plugged into a (GFCI) ground fault circuit interrupting receptacle.

PLUG INTO A GROUNDED ELECTRICAL OUTLET

- Plug power cord into a properly grounded wall outlet.
At this time, you will hear the water pump turn on and start filling the water reservoirs with water. It will take approximately 4 to 5 minutes to fill the water reservoirs for the first time. During this period, the water pump will run continuously, this is normal.

ACTIVATE HEATING AND COOLING SWITCHES

NOTE: The water cooler will not dispense hot or cold water until the switches are turn ON.

To activate the cooling and heating system, turn On the two switches on the back of the water dispenser. See illustration.

Once the switches are activated, both the cooling and heating lights should turn On.

- If you do not want to cool water, keep the switch in the Off position.
- If you do not want to heat water, keep the switch in the Off position.

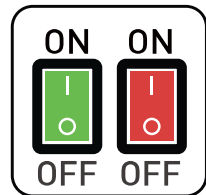

ACTIVATE NIGHTLIGHT

Push top side of blue power switch in to turn light on. Push bottom side in to turn light off.

Part Name

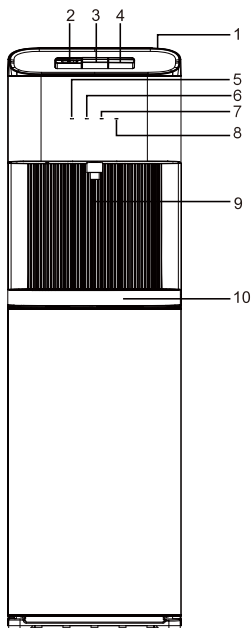

(FRONT)

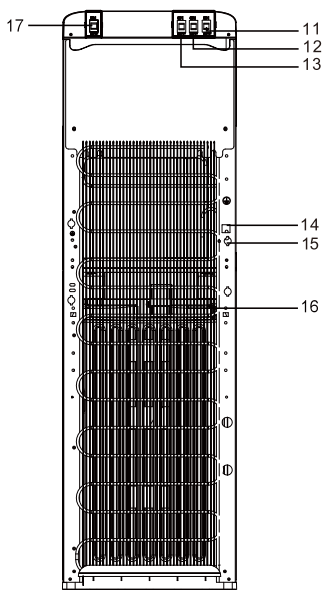

(REAR)

Part	Description
1	Top Cover
2	Hot Water Dispense Button
3	Room Temp. Dispense Button
4	Cold Water Dispense Button
5	Self-Cleaning Indicator Light
6	Heating ON Indicator Light
7	Cooling ON Indicator Light
8	Empty Bottle Indicator Light
9	Water Outlet Spout

Part	Description
10	Drip Tray
11	Hot Water On/Off Switch
12	Cold Water On/Off Switch
13	Nightlight On/Off Switch
14	Power Supply Cord
15	Drain Outlet
16	Condenser
17	Self-Cleaning On/Off Switch

NOTE:

This machine is suitable for 3 or 5 gallon water bottles.
Do not use tap water to refill a 3 or 5 gallon water bottle.

Operation Instructions

This water dispenser has been tested and sanitized prior to packing and shipping. During transit, dust and odors can accumulate in the tank and lines. Dispense and dispose at least one quart of water prior to drinking any water.

Dispensing Cold Water Temperature: (37°F - 50°F / 3°C - 10°C)

Tank Capacity: 3.6L, Flow Rate: 35mL per second / 1.5 L per hour

After setup, cold water will be available in approximately 1-hour. During this time, the compressor will run continuously. This is normal.

Dispensing Hot Water Temperature: (176°F – 199°F / 80°C – 93°C)

Tank Capacity: 1L, Flow Rate: 35mL per second / 1.5 L per hour

⚠ WARNING *This unit dispenses water at temperatures that can cause severe burns. Avoid direct contact with hot water. Keep children and pets away from unit while dispensing. Never allow children to dispense hot water without proper and direct supervision. Unplug unit to prevent unsupervised use by children.*

After setup, hot water will be available in 15 – 20 minutes. During this time, the heating system will start to boil the water inside the tank. This is normal.

WARNINGS & SAFETY PRECAUTIONS

To reduce risk of injury and property damage, user must read this entire guide before assembling & operating dispenser.

Failure to execute the instructions in this manual can cause personal injury or property damage.

Models that heat water dispense at very high temperatures. Failure to use properly can cause person injury.

When operating this dispenser, always exercise basic safety precautions, including the following:

- Prior to use, this dispenser must be properly assembled and installed in accordance with this manual.
- This dispenser is intended for water dispensing only. Do NOT use other liquids. Do NOT use outdoors.
- For indoor use only. Keep water dispenser in a dry place away from direct sunlight. Do NOT use outdoors.
- Install and use only on a hard, flat and level surface.
- Do NOT place dispenser into an enclosed space or cabinet.
- There must be at least 4 inches clearance on the sides of the dispenser to permit airflow.
- The dispenser is intended to be plugged into a ground fault interrupting receptacle.
- Do NOT use an extension cord with your water dispenser.
- Do NOT use this dispenser if cord becomes frayed or otherwise damaged.
- To protect against electric shock, do NOT immerse cord, plug or any other part of dispenser in water or other liquids.

Dispensing Cold Water

- After set-up, it will take 1-hour to get water to the maximum cold water temperature. During this time the compressor will run continuously, this is normal.
 1. Place bottle, glass, pitcher or cooking pot below water outlet spout.
 2. Press cold water dispense button to dispense cold water.
 3. Release button to stop dispensing water.

Dispensing Room Temperature Water

1. Place bottle, glass, pitcher or cooking pot below water outlet spout.
2. Press room temperature dispense button to dispense room temperature water.
3. Release button to stop dispensing water.

Red - Hot Water Button

} - Room Temp Button

* - Cold Water Button



Display Panel Indicator Functions:

The display panel is shown to the right has four display indicator. From left to right the indicator are, O₃ indicator, Heating indicator, Cooling indicator & Empty Bottle Reminder indicator.

1. O₃ indicator-The O₃ indicator light will flash on and off when the water dispenser is first powered on. When the O₃ sterilization module is working, the O₃ sterilization indicator is blinking, and when the O₃ sterilization module stops working, the O₃ sterilization indicator turns off.
2. Heating indicator-The heating indicator turns on when heating, and turns off when hot water reaches set temperature.
3. Cooling indicator-The cooling indicator turns on when cooling, and turns off when cold water reaches set temperature.
4. Empty Bottle Reminder indicator-Empty Bottle indicator Light will flash when the water bottle is empty.

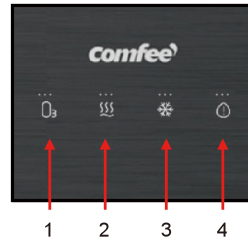

Dispensing Hot Water

⚠ WARNING Hot Water will be extremely hot and produce severe scalding, never let children dispense water without direct adult supervision.

- After set-up, it will take 15 to 20 minutes to get water to maximum hot temperature. During this time the compressor will run continuously, this is normal.
 1. Place bottle, glass, pitcher or cooking pot below water outlet spout.
 2. Slide the red toggle to the left and depress the button to dispense hot water.
 3. Release button to stop dispensing water.

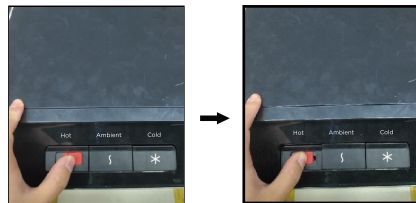

Empty Water Bottle Indicator Flashing

⚠ WARNING Do not dispense water if the empty water bottle indicator is flashing, doing so may cause the hot water to overheat and cause damage to the hot water heater.

- Empty Bottle indicator Light will flash when the water bottle is empty.
Replace the empty water bottle as soon as possible.



How To Replace Empty Water Bottle

1. Open the cabinet door.
2. Place the probe assembly on the probe hanger.
3. Place a fresh bottle outside of cabinet.
4. Remove the entire plastic cap from the top of bottle.
5. Clean the outside of the new bottle with a cloth.

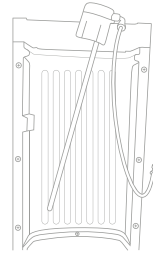

6. Place the probe into the bottle.
7. Slide the collar down until it clicks into place. If you are using a 3 gallon bottle rather than a 5 gallon bottle you can adjust probe by pressing the two tabs at the head of the probe and sliding the collar down to the neck of the bottle.

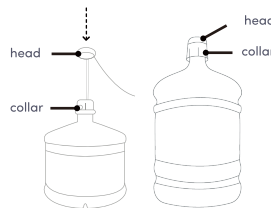
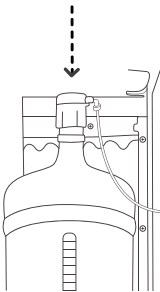

8. Push the head down until the tube hits the bottom of bottle.
9. Slide the bottle into cabinet and close the door.

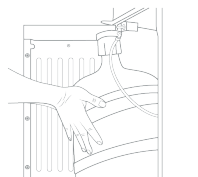
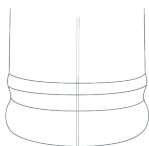

Use the Self-Cleaning Ozone Feature

It is highly recommended that you use self-cleaning feature on weekly basis to clean tanks and water lines.

To activate the self-cleaning cycle, press in the self-cleaning switch(15), hold for 5 seconds, and release.

The power indicator light on the front of the dispenser will begin blinking, indicating the cleaning process is underway.

During the cleaning cycle, ozone is produced and injected into the water system.

This ozone helps to kill bacteria and biofilms typically found in water dispensers. By the time the cleaning cycle ends, the ozone is converted to harmless oxygen and emitted into the air.

⚠ IMPORTANT: The cycle takes 90 minutes to complete. During this time do not dispense and drink the water.

Doing so may result in an odd taste. For your convenience, we recommend that you do this during a period when the dispenser is not in use, such as overnight hours or when staff is away from the office. During the cycle you may smell a faint trace of ozone.

DEEP CLEANING

⚠ WARNING To avoid electrical shock, unplug the water dispenser before performing the cleaning operation.

⚠ WARNING This cleaning procedure should be performed by an adult.

⚠ WARNING The hot water is extremely hot and can cause severe burns, please allow the water dispenser to cool off before performing the cleaning operation.

- The water dispenser was disinfected before shipping from the factory. However, prior to use, please clean the external cabinet and dispenser at least 0.5 gallon(2 liters) of water prior to use.
- Perform this cleaning operation every 3 to 6 months.

Rinsing, Cleaning, and Draining

To prolong the lifetime of the machine, it is recommended that the unit be cleaned and sanitized manually about every six months.

To clean the outside of the unit

Use a disinfectant of your choice to wipe down the outside of the machine. Disinfectant does not come with this unit. It can be purchased separately from a local store.

To rinse the inside of the unit

The machine has been disinfected prior to departing from the factory. However, it is recommended to rinse and drain the unit prior to installation.

Remove the white cold water tank cover and the separator.

1. Before cleaning, make sure that the cooling switch and heating switch are in the off (O) position and unplug the machine.
2. Remove the two screws located on the back (at the top, in line with the switches) of the cooler. Remove the top cover by lifting at an angle and pull off.

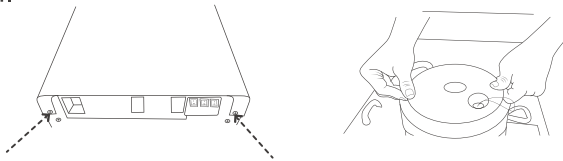

3. Pour 0.6 gallons of clean water into the cold tank. (The cold water tank is the open cylinder that the white cover was removed from).
4. Place a large bucket beneath the drain outlet located on the back of the unit. Remove the drain cover and allow the water to drain from the unit. Water will start flowing as soon as the drain cover is removed.

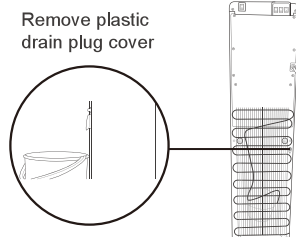

⚠ WARNING The dispenser will heat water to a temperature of approximately 194°F. It can cause severe burns if not handled carefully. Please use caution while operating and cleaning. Please allow ample time for any hot water inside the machine to cool down before draining it.

-
- Once water is completely drained, reposition the drain cover, cold tank cover and the top cover. Ensure that the pipes and wires are connected properly and you may use the dispenser as normal.

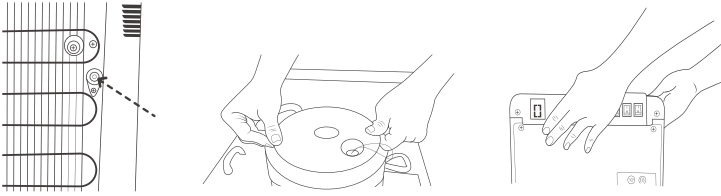

Cleaning:

To remove mineral deposits from the water system, mix 1-gallon of water with 200 grams of citric acid crystals (not included) or a citric acid cleaning solution of your choice.

- Unscrew the top cover and lift off the cold tank lid.

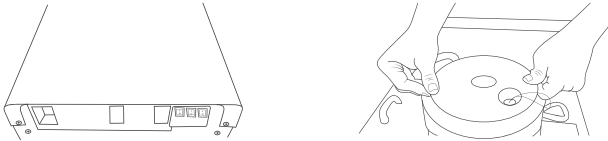

- Place a large bucket beneath the drain outlet located on the back of the unit. Remove the drain cover and allow the water to drain from the unit. Water will start flowing as soon as the drain cover is removed.

⚠ WARNING The dispenser will heat water to a temperature of approximately 194°F. It can cause severe burns if not handled carefully. Please use caution while operating and cleaning. Please allow ample time for any hot water inside the machine to cool down before draining it.

- Once water is completely drained, reposition the drain cover so water does not drain into bucket.
- Put the mixture into the machine's cold tank.
- Plug in the power cord and turn on (I) the heating switch . Allow the water to heat for 15 minutes.
- Turn off the heating switch and allow the liquid mixture to cool down for 20 minutes.
- Drain the liquid from the drain outlet. Flush water system with fresh water two or three times by following the rinsing instructions above. Only disassemble parts mentioned to avoid damaging the machine.

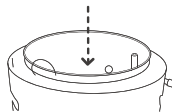

Trouble Shooting

Problem	Possible Cause	Suggested Solution
Water dispenser is leaking	Drain outlet is not secure.	Tighten drain cap
	Internal water leak.	Unplug and replace unit
Water dispenser is not dispensing water	Empty water bottle.	Replace empty water bottle
	Child safety lock (hot water) is not activated	Activate the child safety lock by sliding the red lock button to the side while pressing the hot water button at the same time.
	Thermostat is set too cold.	Turn off cooling system for 4-hours and retest faucets for water flow.
Water is not cold or hot enough	The unit is unplugged	Plug into electrical outlet
	Cold or hot water On/Off switches, located in the back of the unit are in the Off position	Activate power switches to the ON position
	All the water in the tanks has been used	Replace with full water bottle and wait for the water to heat or cool.
	The circuit breaker in your home has tripped or the fuse has blown	Unplug water cooler and reset the breaker or replace the fuse.
	Lower door is not closed shut	Make sure the lower door is properly closed.
Water Dispenser is noisy	Water dispenser placed on uneven floor	Make sure the dispenser is on an even floor surface.
	Water pump makes a noise when running	This is a normal noise.

Warnings and Safety Precautions

To reduce risk of injury and property damage, user must read this entire guide before assembling & operating dispenser.

Failure to execute the instructions in this manual can cause personal injury or property damage.

Models that heat water dispense at very high temperatures. Failure to use properly can cause person injury.

When operating this dispenser, always exercise basic safety precautions, including the following:

- Prior to use, this dispenser must be properly assembled and installed in accordance with this manual.
- This dispenser is intended for water dispensing only. Do NOT use other liquids. Do NOT use outdoors.
- For indoor use only. Keep water dispenser in a dry place away from direct sunlight. Do NOT use outdoors.
- Install and use only on a hard, flat and level surface.
- Do NOT place dispenser into an enclosed space or cabinet.
- There must be at least 4 inches clearance on the sides of the dispenser to permit airflow.
- The dispenser is intended to be plugged into a ground fault interrupting receptacle.
- Do NOT use an extension cord with your water dispenser.
- Do NOT use this dispenser if cord becomes frayed or otherwise damaged.
- To protect against electric shock, do NOT immerse cord, plug or any other part of dispenser in water or other liquids.
- If the supply cord is damaged, it must be replaced by an original manufacture part. Please contact customer service.

⚠ WARNING To avoid electrical shock, unplug the water dispenser before performing the cleaning operation.

⚠ WARNING All cleaning procedure should be performed by an adult.

⚠ WARNING *This unit dispenses water at temperatures that can cause severe burns. Avoid direct contact with hot water. Keep children and pets away from unit while dispensing. Never allow children to dispense hot water without proper and direct supervision. Unplug unit to prevent unsupervised use by children.*

⚠ WARNING *Before removing the Drain Outlet Plug, allow the water dispenser to sit and cool down for 45-minutes. The water will drain directly from the hot tank, if water is not properly cooled, this unit dispenses water at temperatures that can cause severe burns. Avoid direct contact with hot water. Keep children and pets away from unit while dispensing & deep cleaning. Never allow children to dispense hot water without proper and direct supervision. Unplug unit to prevent unsupervised use by children.*

TECHNICAL PARAMETERS

MODEL	CWB41D4AST
Hot Water Capacity	1 gal/h
Hot Tank Volume	1/3 gal
Cold Water Capacity	2/3 gal/h
Cold Tank Volume	1 gal
Package Dimensions	15.2 x 14 x 43.9"
Refrigerant	R134a/36g(1.27oz)
High Side	1.6MPa(232psig)
Low Side	0.62MPa(90psig)
Voltage / Frequency / Current	115V/60Hz/6A
Cooling Method	Compressor
Heating Method	Internal Element
Rated Power	520W
Heating Power	420W

1 YEAR LIMITED WARRANTY

This is the only express warranty for this product and is in lieu of any other warranty or condition.

This product is warranted to be free from defects in material and workmanship for a period of one (1) year from the date of original purchase. During this period, your exclusive remedy is repair or replacement of this product or any component found to be defective, at our option; however, you are responsible for all costs associated with returning the product to us and our returning the product or component under this warranty to you. If the product or component is no longer available, we will replace with a similar one of equal or greater value.

This warranty does not cover wear from normal use or operation that does not comply with the instruction manual or damages to the product resulting from accident, alteration, abuse, or misuse. This warranty extends only to the original consumer purchaser or gift recipient. Keep the original sales receipt, as proof of purchase is required to make a warranty claim. This warranty is void if product is used for other than single-family household use or subjected to any voltage and waveform other than as specified on the label.

We exclude all claims for special, incidental, and consequential damages by breach of express or implied warranty. All liability is limited to amount of the purchase price. Every implied warranty, including any statutory warranty or condition of merchantability or fitness for particular purpose, is disclaimed except to the extent prohibited by law, in which case such warranty or condition is limited to the duration of this written warranty.

This warranty gives you specific legal rights. You may have other legal rights that vary depending on where you live. Some states or provinces do not allow limitations on implied warranties or special, incidental consequential damages, so the foregoing limitations may not apply to you.

Customer Service Phone: 1-866-646-4332

