



USER MANUAL

Direct Drinking Water Purifier

Rated Power: 520W

Voltage: 115V

Frequency: 60Hz

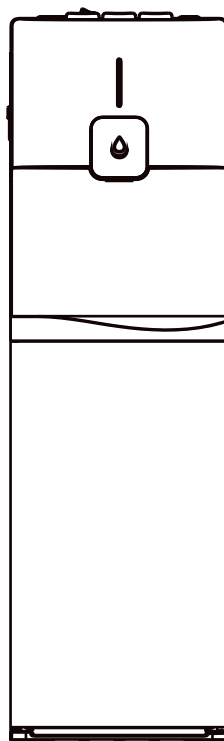

**Free 3 months
extension of the
original limited warranty
period!*** Simply text a
picture of your proof of
purchase to:

1-844-224-1614

*The warranty extension is for the
three months immediately following
the completion of the product's
original warranty period.

Model Numbers CWD412AST

TABLE OF CONTENTS

	page
Safety information-----	1
Installation and safety precautions-----	4
Part name-----	5
Dispensing water -----	6
Deep cleaning-----	7
Use guide-----	10
Trouble shooting-----	13
Technical parameters -----	14
1 Year limited warranty -----	14



WARNING

ELECTRICAL REQUIREMENTS

A 115 V, 60 Hz, AC only, 15 A or 20 A fused, grounded electrical supply is required. It is recommended that a separate circuit serving only your water purifier be provided. Use an outlet that cannot be turned off by a switch. Do not use an extension cord.

FAILURE TO FOLLOW THESE INSTRUCTIONS CAN RESULT IN DEATH, FIRE OR ELECTRICAL SHOCK.

⚠ WARNING To reduce the risk of injury and property damage, user must read this entire guide before assembling, installing and operating water purifier.

⚠ WARNING Failure to execute the instructions in this manual can cause personal injury or property damage.

⚠ WARNING This product dispenses hot water above 176°F, failure to use properly can cause personal injury. Never allow children to dispense hot water without proper adult supervision.

⚠ WARNING This water purifier is equipped with a power cord having a grounded wire and must be connected into a properly grounded polarized outlet. Consult a qualified electrician if the grounding instructions are not completely understood.

⚠ WARNING If the wall outlet is a standard 2-prong outlet, it is your personal responsibility and obligation to have it replaced with a properly grounded 3-prong wall outlet. DO NOT cut or remove the third (ground) prong from the water dispenser power cord.

⚠ WARNING DO NOT use adapter plugs or an extension cord with your water purifier.

⚠ WARNING DO NOT use purifier if power cord becomes frayed or otherwise damaged.

⚠ WARNING This appliance must be grounded, in the event of an electrical short circuit, grounding reduces the risk of electrical shock.

⚠ WARNING When operating this purifier, always exercise basic safety precautions, including the following:

- Prior to use, this purifier must be properly assembled and installed in accordance with this manual.
- For indoor use only, keep the water purifier in a dry place away from direct sunlight. DO NOT use water purifier outdoors.
- Install and use water purifier on hard, flat and level surface and install the safety brackets according to the Water Purifier Installation procedure.
- DO NOT place water purifier inside an enclosed space or cabinet.
- DO NOT operate water purifier in the presence of explosive fumes.
- Water purifier must be positioned no closer than 8" (20 cm) from wall to permit free airflow between wall and back of purifier. There must be at least 8" (20 cm) clearance on the sides of the water dispenser to permit airflow.

-
- Always grasp the power cord plug and pull straight out from the wall outlet, never unplug by pulling on the power cord.

⚠ WARNING When operating this purifier, always exercise basic safety precautions, including the following:

- This appliance can be used by children 8-years and above if properly supervised by an adult or given supervision or instruction concerning use of the appliance in a safe way and if they understand the hazards involved.
- Cleaning and user maintenance shall not be made by children unless they are older than 8 and supervised by an adult. Keep the appliance and its cord out of reach of children less than 8-years old.
- Appliances can be used by persons with reduced physical, sensory, or mental capabilities or lack of experience and knowledge if they have been given supervision or instruction concerning use of the appliance in a safe way and understand the hazards involved. Children shall not play with the appliance.
- For household use only. This appliance is intended to be used in a household and similar applications.
- Do not store explosive substances such as aerosol cans with a flammable propellant in this appliance.
- If the supply cord is damaged, it must be replaced by an original manufacture part. Please contact customer service.
- Never turn the machine upside down or lean it more than 45 degrees.
- The thermostat has been factory adjusted for optimum performance. No need to adjust it by yourself. When the machine is below the freezing point, ice will form inside the cold tank and potentially block water flow. If this happens, turn Off the cooling switch for 4-hours to melt the ice block. Once melted, water should start to flow from faucets.
- The machine should not be turned On until 3-minutes after turning off the power switch.

⚠ WARNING UV light source. Disconnect the electrical supply to the UV radiation BEFORE opening cover.

- UV-LED lamp must be repaired by manufacturer only.
- UV-LED lamp model no. H-MD024CA, rated DC 24V, 0.4W.
- Disposal of the UV-LED lamp must be done in accordance with local laws and regulations.

⚠ WARNING To prevent the water purifier from tipping, please install the enclosed two safety brackets.

1. Loosen the two screws on the back lower left and right side of the water purifier. (Refer to illustration on right.)
2. Slide safety bracket under the loose screw and secure the safety bracket to the water purifier by tightening the screws.
3. Using the safety bracket as a template, secure the safety bracket to the floor's surface where the water purifier is to be installed. (Make sure the back of the water purifier is at least 8" from wall for proper air-flow.)
4. Secure the two safety brackets to the floor by tightening the two screws.

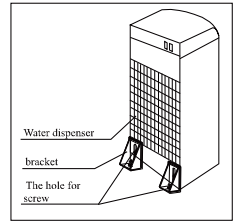

INSTALLATION AND SAFETY PRECAUTIONS

LOCATE PURIFIER

NOTE: If the unit has been on its side for a long period of time, place the water purifier in the upright position for more than 24-hours before turning it on.

1. Place purifier in its upright position.
2. Locate purifier on a hard and level surface and in a cool shaded location, near a grounded outlet and main water supply
3. Connect the main water supply to the water cooler, please refer to "Guidance on Unpacking and Installation" procedure on pages 10 through 12.
4. Once the water purifier is plumbed and leak free, position the water purifier so the back and sides are 8"(20 cm) clearance on all sides.
5. Plug in power cord.
6. Turn on main water supply and water purifier water valve. (Note: you will hear water running, this indicates the water reservoir's are filling.)
7. Turn on Cooling and Heating switches.

ASSEMBLE DRIP TRAY

1. Assemble the drip tray cover to the drip tray.
2. Install drip tray and cover onto the lower front door by sliding in until you hear a click.

PLUG INTO A GROUNDED ELECTRICAL OUTLET

Plug power cord into a properly grounded wall outlet.

ACTIVATE HEATING AND COOLING SWITCHES

NOTE: The water cooler will not dispense hot or cold water until the switches are turn ON. Do not turn ON switches until water is plumbed and ready to be used.

To activate the cooling and heating system, turn On the two switches on the back of the water purifier. See illustration.

Once the switches are activated, both the cooling and heating lights should turn On.

- If you do not want to cool water, keep the switch in the Off position.
- If you do not want to heat water, keep the switch in the Off position.

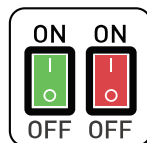

ACTIVATE NIGHTLIGHT

Push top side of blue power switch in to turn light on. Push bottom side in to turn light off.

PART NAME

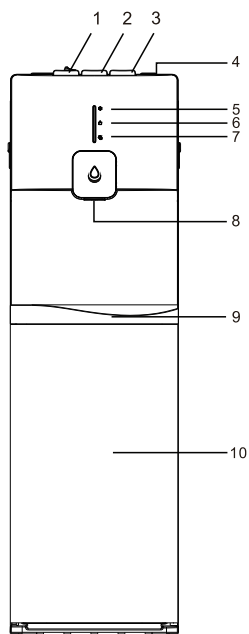

(FRONT)

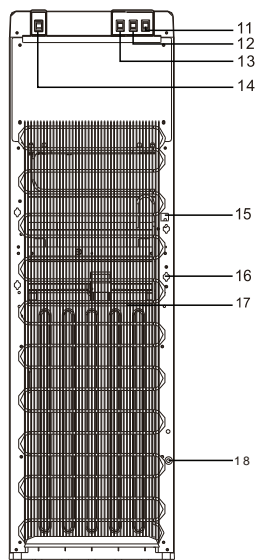

(REAR)

Part	Description
1	Hot Water Dispense Button
2	Room Temp. Dispense Button
3	Cold Water Dispense Button
4	Top Cover
5	Cooling Indicator Light
6	Heating Indicator Light
7	UV Indicator Light
8	Water Faucet
9	Drip Tray

Part	Description
10	Door
11	Heating Switch
12	Cooling Switch
13	Nightlight Switch
14	Filter element reset switch
15	Power Supply Cord
16	Drain Outlet
17	Condenser
18	Water Inlet

NOTE:

Please use the product in a place with ambient temperature between 39.2°F-100.4°F and a relative humidity less than 90%, for optimal performance.

Working Principle

1.Flowchart of water generation

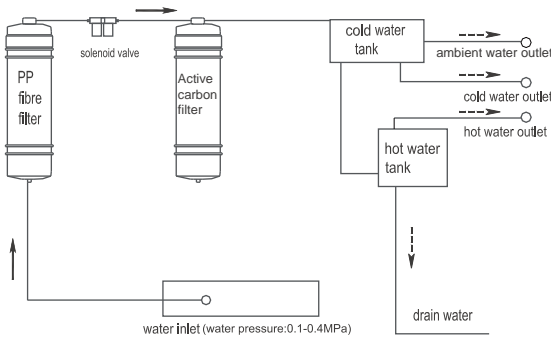

2.Circuit diagram

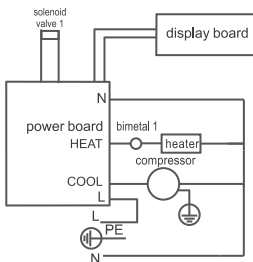

Filter function introduction

Stage	Filter	Function
Stage 1	PP fibre filter	Carry out coarse filtration of original water, and filter out mud, sand, impurity, iron rust and suspension, etc.
Stage 2	Active carbon filter	Absorb unusual colors and odors, Remove residual chlorine and organic substances in water.

DISPENSING WATER

This unit has been tested and sanitized prior to packing and shipping. During transit dust and odors can accumulate in the tank and lines. Dispense and dispose at least one quart of water prior to drinking any water.

Dispensing Cold Water

- After set-up, it will take 1-hour to get water to the maximum cold water temperature. During this time the compressor will run continuously, this is normal.
- 1. Place bottle, glass, pitcher or cooking pot below water outlet spout.
- 2. Press cold water dispense button to dispense cold water(Dark Blue Button).
- 3. Release button to stop dispensing water.

Dispensing Room Temperature Water

1. Place bottle, glass, pitcher or cooking pot below water outlet spout.
2. Press room temperature dispense button to dispense room temperature water.(Light Blue Button)
3. Release button to stop dispensing water.

Red - Hot Water Button

Light Blue - Room Temp Button

Dark Blue - Cold Water Button



Dispensing Hot Water

⚠ WARNING Hot Water will be extremely hot and produce severe scalding, never let children dispense water without direct adult supervision.

- After set-up, it will take 15 to 20 minutes to get water to maximum hot temperature. During this time the compressor will run continuously, this is normal.
1. Place bottle, glass, pitcher or cooking pot below water outlet spout.
 2. Slide the red toggle to the left and depress the button to dispense hot water.
 3. Release button to stop dispensing water.

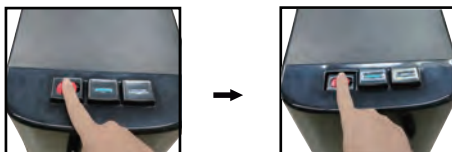

DEEP CLEANING

⚠ WARNING To avoid electrical shock, unplug the water purifier before performing the cleaning operation.

⚠ WARNING This cleaning procedure should be performed by an adult.

⚠ WARNING The hot water is extremely hot and can cause severe burns, please allow the water purifier to cool off before performing the cleaning operation.

- The water purifier was disinfected before shipping from the factory. However, prior to use, please clean the external cabinet and purifier at least 0.5 gallon(2 liters) of water prior to use.
- Perform this cleaning operation every 3 to 6 months.

Rinsing, Cleaning, and Draining

To prolong the lifetime of the machine, it is recommended that the unit be cleaned and sanitized manually about every six months.

To clean the outside of the unit

Use a disinfectant of your choice to wipe down the outside of the machine. Disinfectant does not come with this unit. It can be purchased separately from a local store.

To rinse the inside of the unit

The machine has been disinfected prior to departing from the factory. However, it is recommended to rinse and drain the unit prior to installation.

Remove the white cold water tank cover and the separator.

1. Before cleaning, make sure that the cooling switch and heating switch are in the off (O) position and unplug the machine.
2. Remove the two screws located on the back (at the top, in line with the switches) of the cooler. Remove the top cover by lifting at an angle and pull off.

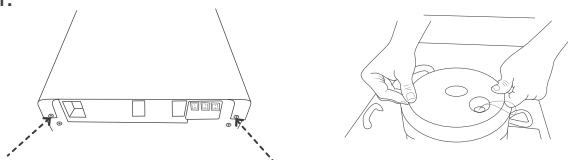

3. Pour 0.6 gallons of clean water into the cold tank. (The cold water tank is the open cylinder that the white cover was removed from).
4. Place a large bucket beneath the drain outlet located on the back of the unit. Remove the drain cover and allow the water to drain from the unit. Water will start flowing as soon as the drain cover is removed.

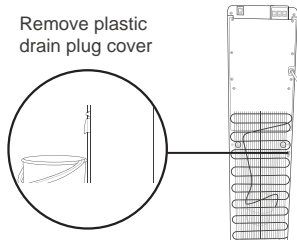

⚠ WARNING The dispenser will heat water to a temperature of approximately 194°F. It can cause severe burns if not handled carefully. Please use caution while operating and cleaning. Please allow ample time for any hot water inside the machine to cool down before draining it.

-
- Once water is completely drained, reposition the drain cover, cold tank cover and the top cover. Ensure that the pipes and wires are connected properly and you may use the purifier as normal.

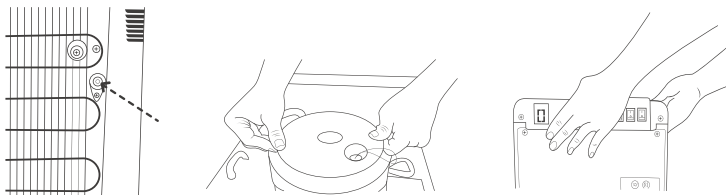

Cleaning:

To remove mineral deposits from the water system, mix 1-gallon of water with 200 grams of citric acid crystals (not included) or a citric acid cleaning solution of your choice.

- Unscrew the top cover and lift off the cold tank lid.

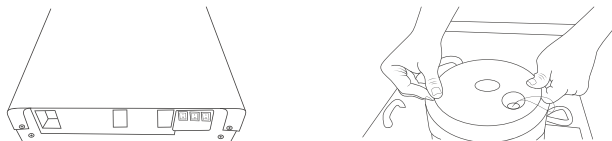

- Place a large bucket beneath the drain outlet located on the back of the unit. Remove the drain cover and allow the water to drain from the unit. Water will start flowing as soon as the drain cover is removed.

⚠ WARNING The purifier will heat water to a temperature of approximately 194°F. It can cause severe burns if not handled carefully. Please use caution while operating and cleaning. Please allow ample time for any hot water inside the machine to cool down before draining it.

- Once water is completely drained, reposition the drain cover so water does not drain into bucket.
- Put the mixture into the machine's cold tank.
- Plug in the power cord and turn on (I) the heating switch . Allow the water to heat for 15 minutes.
- Turn off the heating switch and allow the liquid mixture to cool down for 60 minutes.
- Drain the liquid from the drain outlet. Flush water system with fresh water two or three times by following the rinsing instructions above. Only disassemble parts mentioned to avoid damaging the machine.

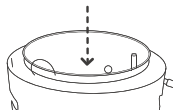

USE GUIDE

Guidance on Unpacking and Installation

1. Turn off the current cold water supply that is the source of water to your sink.

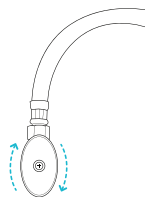

2. Disconnect the current cold water supply line under your sink.

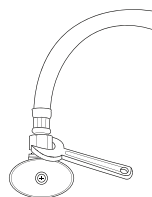

3. Connect the Metal Adapter with Valve between the cold water supply line and cold water valve.

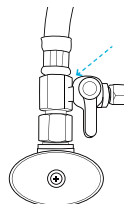

4. Remove the nut from the Metal Adapter and insert the PE Tubing through the nut. Slide the PE Tubing onto the protruding part of the Adapter where the nut was located until it reaches the threading. The PE pipe should use the new pipe that comes with the product, and the old hose assembly cannot be reused.

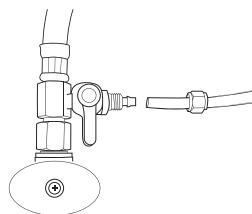

5. Screw the nut tightly into place to keep the PE Tubing securely connected to the Metal Adapter with Valve. Make sure the Valve is in the off position (perpendicular to the PE Tubing).

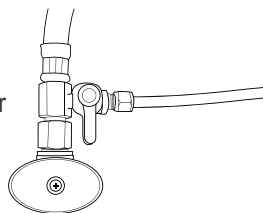

6. Use the after sale accessory -- filter flushing tip, the arrow direction is the water flow direction, insert the PE pipe in the quick joint.

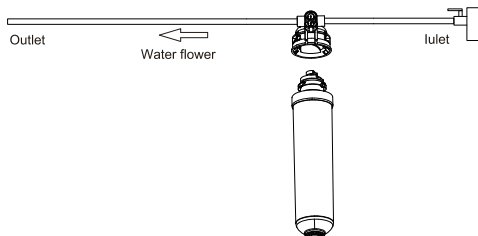

7. Insert the active carbon filter into the filter flushing tip, tighten it by turning anticlockwise, and open the water tap to flush the filter till it doesn't discharge black water, for about 10min.
8. Install the clean filter in the product, hold the filter with the left hand and enclosure of filter with the right hand, and insert it upwards in the filter, tighten it by turning anticlockwise, the installation order is: PP sediment filter → Active carbon filter.

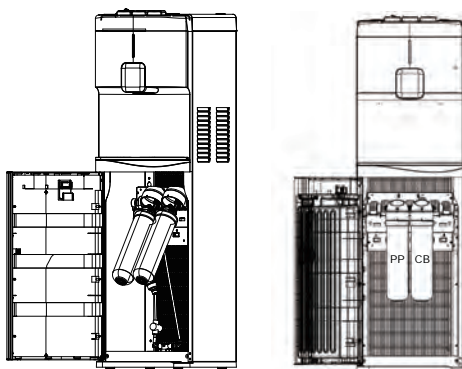

9. Remove the plug from the water inlet located on the back of the unit. To do this press on the push connect ring that is behind the plug. Push the open end of the PE Tubing into the water inlet. Make sure the PE Tubing is tight and secure.

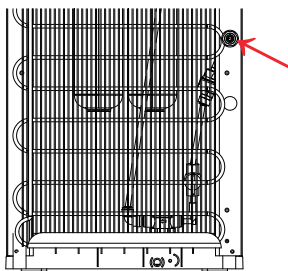

10. Turn on the Valve that is located to the left of the filters inside of the cabinet (the on position is parallel to the PE Tubing).

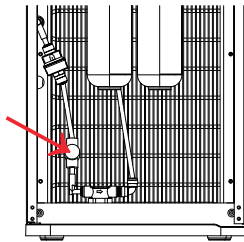

11. After installing the water line, plug in the unit and use it normally.
12. When replacing a filter, please unplug the water purifier and turn off the main water supply. Note: some water will drip and spill out from the filter connections, have bucket and towel ready to clean up any spills of water.
13. Before installing new filter, remember to flush out the filter as described in the section above.

The Display Panel is Shown as Below

1.1 The display panel is shown as below:
From the top to bottom: Cooling, Heating, UV.

1.2 Requirements on Functions

1.2.1 Heating Icon

The heating icon lights on when heating, and it lights off after heating or don't heating.

1.2.2 Cooling Icon

The cooling icon lights on when cooling, and it lights off after cooling or don't cooling.

1.2.3 UV Icon

The UV icon lights on when working, and it lights off when work is finished over or not working.



Filter Replacement Cycle

PP fibre filter	Active carbon filter
3-6 months	6-12 months

Special hints:
The data above are for references only. It is based on 10L per daily drinking water.
The specific cycle for replacement of filters varies with local water quality and water amount consumed.

TROUBLE SHOOTING

In case of failure, please carry out inspection according to the requirements below. If unresolved, please contact the local service agency.

Problem	Possible Cause	Suggested Solution
Small water flow	Low water pressure	Check water inlet supply line and water valve is in ON position Check PE tube for kinks, straighten
	Filters needs replacement	Please reference User Manual on how to replace filter
Unsuitable water temperature	Over consumption of water in a short time	Just wait a moment, and water is available again
	Cooling or hot water switch in the off position	Turn on cooling or heating switches
	Power supply is turned off	LEDs on front panel should be on, if not check power supply to unit.
Water leakage	Pipe not connected properly	Inspect the connector to connect the pipe properly
	Water pipe and PE pipe bursting	Replace the water pipe and PE pipe
Electric leakage	Machine in poor contact with ground	Use a three-pin socket with earth wire, making the machine grounded properly
Noisy operation	Not installed steadily	Place the machine on a steady & solid surface
Machine fails to run	Power supply is turned off	Power supply is turned off

It is a normal state that the following circumstances occur when the water purifier is used.

1. During the heating, the heating tube may generate slight noises. This is a normal state.
2. When the heating tank is being heated without water, the anti dry-burning device will disconnect automatically and can not reset by its own. The reset must be completed by a professional technician. The design is in accordance with the national safety requirements.
3. When an ambient temperature is higher, the cooling capacity may be slower, which is a normal state.

TECHNICAL PARAMETERS

MODEL	CWD412AST
Voltage / Frequency / Current	115V / 60Hz / 6A
Rated Power	520W
Heating Power	420W
Refrigerating Power	100W
Water Flow Rate	0.31gal/min(43.51psig)
Hot Water Capacity	1.05gal/h($\geq 185^{\circ}\text{F}$)
Cold Water Capacity	0.52gal/h($\leq 50^{\circ}\text{F}$)
Applicable Environment	39.2°F-100.4°F humidity $\leq 90\%$
Applicable Water Pressure	14.5-60psig
Applicable Water	Tap water
Stage 1	PP fibre filter
Stage 2	Active carbon filter

1 YEAR LIMITED WARRANTY

This is the only express warranty for this product and is in lieu of any other warranty or condition.

This product is warranted to be free from defects in material and workmanship for a period of one (1) year from the date of original purchase. During this period, your exclusive remedy is repair or replacement of this product or any component found to be defective, at our option; however, you are responsible for all costs associated with returning the product to us and our returning the product or component under this warranty to you. If the product or component is no longer available, we will replace with a similar one of equal or greater value.

This warranty does not cover wear from normal use or operation that does not comply with the instruction manual of damages to the product resulting from accident, alteration, abuse, or misuse. This warranty extends only to the original consumer purchaser or gift recipient. Keep the original sales receipt, as proof of purchase is required to make a warranty claim. This warranty is void if product is used for other than single-family household use or subjected to any voltage and waveform other than as specified on the label.

We exclude all claims for special, incidental, and consequential damages by breach of express or implied warranty. All liability is limited to amount of the purchase price. Every implied warranty, including any statutory warranty or condition of merchantability or fitness for particular purpose, is disclaimed except to the extent prohibited by law, in which case such warranty or condition is limited to the duration of this written warranty.

This warranty gives you specific legal rights. You may have other legal rights that vary depending on where you live. Some states or provinces do not allow limitations on implied warranties or special, incidental consequential damages, so the foregoing limitations may not apply to you.

Customer Service Phone: 1-844-224-1614